

Ref# 72001547

NATIONAL REGISTER OF HISTORIC PLACES
INVENTORY - NOMINATION FORM

(Type all entries - complete applicable sections)

| | |
|-------------------|----------|
| STATE: Ohio | |
| COUNTY: Summit | |
| FOR NPS USE ONLY | |
| ENTRY NUMBER | DATE |
| | 12-15-72 |

1. NAME

COMMON:
Chuckery Race (Gorge Metropolitan Park)

AND/OR HISTORIC:

2. LOCATION

STREET AND NUMBER:
(see continuation sheet)

CITY OR TOWN:
Cuyahoga Falls

STATE: Ohio CODE: 039 COUNTY: Summit CODE: 153

3. CLASSIFICATION

| CATEGORY (Check One) | OWNERSHIP | STATUS | ACCESSIBLE TO THE PUBLIC |
|---|--|---|---|
| <input type="checkbox"/> District <input type="checkbox"/> Site <input type="checkbox"/> Building <input checked="" type="checkbox"/> Structure <input type="checkbox"/> Object | <input checked="" type="checkbox"/> Public <input type="checkbox"/> Private <input type="checkbox"/> Both | Public Acquisition: <input type="checkbox"/> In Process <input type="checkbox"/> Being Considered | <input checked="" type="checkbox"/> Occupied <input type="checkbox"/> Unoccupied <input type="checkbox"/> Preservation work in progress |
| PRESENT USE (Check One or More as Appropriate) | | | |
| <input type="checkbox"/> Agricultural <input type="checkbox"/> Commercial <input type="checkbox"/> Educational <input type="checkbox"/> Entertainment | <input type="checkbox"/> Government <input type="checkbox"/> Industrial <input type="checkbox"/> Military <input type="checkbox"/> Museum | <input checked="" type="checkbox"/> Park <input type="checkbox"/> Private Residence <input type="checkbox"/> Religious <input type="checkbox"/> Scientific | <input type="checkbox"/> Transportation <input type="checkbox"/> Other (Specify) |

4. OWNER OF PROPERTY

OWNER'S NAME:
Akron Metropolitan Park DISTRICT

STREET AND NUMBER:
975 TRIATY LINE ROAD

CITY OR TOWN:
Akron

STATE: Ohio CODE: 039

5. LOCATION OF LEGAL DESCRIPTION

COURTHOUSE, REGISTRY OF DEEDS, ETC:
Summit County Court House

STREET AND NUMBER:
209 South High Street

CITY OR TOWN:
Akron

STATE: Ohio CODE: 039

6. REPRESENTATION IN EXISTING SURVEYS

TITLE OF SURVEY:

DATE OF SURVEY: Federal State County Local

DEPOSITORY FOR SURVEY RECORDS:

STREET AND NUMBER:

CITY OR TOWN: STATE: CODE:

SEE INSTRUCTIONS

STATE: Ohio
COUNTY: Summit
ENTRY NUMBER
DATE

FOR NPS USE ONLY

7. DESCRIPTION

| | | | | | | |
|-----------|------------------------------------|---|--------------------------------|---|--------------------------------|------------------------------------|
| CONDITION | (Check One) | | | | | |
| | <input type="checkbox"/> Excellent | <input checked="" type="checkbox"/> Good | <input type="checkbox"/> Fair | <input type="checkbox"/> Deteriorated | <input type="checkbox"/> Ruins | <input type="checkbox"/> Unexposed |
| | (Check One) | | | (Check One) | | |
| | <input type="checkbox"/> Altered | <input checked="" type="checkbox"/> Unaltered | <input type="checkbox"/> Moved | <input checked="" type="checkbox"/> Original Site | | |

DESCRIBE THE PRESENT AND ORIGINAL (if known) PHYSICAL APPEARANCE

The Chuckery Race is a structure constructed of hand cut sandstone blocks forming a wall eight to ten feet in height and about 1300 yards long. The wall is parallel to and about 30 feet from the sheer rock of the east wall of the Cuyahoga River Gorge. The rock was quarried on site from the east wall of the Gorge. The construction of the rock wall created a water channel eight feet deep and thirty feet wide. This raceway supplied waterpower to the industrial allotment of "Summit City". At the northernmost point of Chuckery Race, a dam and gate were constructed to divert water into the raceway. Though they no longer exist, their locations and rock boulder to which they were anchored are still evident.

This portion of Chuckery Race has remained largely intact since its construction in 1844. The storm drainage along with the natural drainage of the area have helped fill in the Chuckery Race with soil; trees as well as low foliage are presently growing in this area. To prevent water from flowing into it, a hand-cut sandstone wall was constructed where the gate opening was located for the raceway. The flood of 1913 did no damage to the stone wall, and it remains completely intact.

The southerly portion of Chuckery Race was constructed as a result of dirt fill and excavation and is about three miles in length. Natural erosion has filled in and eroded this area over the years, however, some of its characteristics and major features can still be noted. Most of this area is used by Ohio Edison as a right-of-way for main power lines.

At the present time, the Ohio Department of Highways is in the process of constructing, with Federal Funds, the Moulton Highway. It is adjacent to and above the rim of the east wall of the Cuyahoga River Gorge. The freeway drainage through this portion of the City of Cuyahoga Falls will prove to be detrimental to the preservation of the Chuckery Race and to the plant life within it. Severe erosion and freeway salt are the two primary elements which are endangering this area. The intent is to preserve the Chuckery Race and to provide an area which can be preserved and developed in conjunction with the Akron Metropolitan Park District. It is hoped that the freeway drainage system can be redesigned to prevent harm to Chuckery Race.

SEE INSTRUCTIONS

6. SIGNIFICANCE

PERIOD (Check One or More as Appropriate)

- | | | | |
|--|---------------------------------------|--|---------------------------------------|
| <input type="checkbox"/> Pre-Columbian | <input type="checkbox"/> 16th Century | <input type="checkbox"/> 18th Century | <input type="checkbox"/> 20th Century |
| <input type="checkbox"/> 15th Century | <input type="checkbox"/> 17th Century | <input checked="" type="checkbox"/> 19th Century | |

SPECIFIC DATE(S) (If Applicable and Known)

May 27, 1844

AREAS OF SIGNIFICANCE (Check One or More as Appropriate)

- | | | | |
|--|---|--|--|
| <input type="checkbox"/> Aboriginal | <input type="checkbox"/> Education | <input type="checkbox"/> Political | <input type="checkbox"/> Urban Planning |
| <input type="checkbox"/> Prehistoric | <input checked="" type="checkbox"/> Engineering | <input type="checkbox"/> Religion/Philosophy | <input type="checkbox"/> Other (Specify) |
| <input type="checkbox"/> Historic | <input checked="" type="checkbox"/> Industry | <input type="checkbox"/> Science | _____ |
| <input type="checkbox"/> Agriculture | <input type="checkbox"/> Invention | <input type="checkbox"/> Sculpture | _____ |
| <input type="checkbox"/> Architecture | <input type="checkbox"/> Landscape Architecture | <input type="checkbox"/> Social/Humanitarian | _____ |
| <input type="checkbox"/> Art | <input type="checkbox"/> Literature | <input type="checkbox"/> Theater | _____ |
| <input type="checkbox"/> Commerce | <input type="checkbox"/> Military | <input type="checkbox"/> Transportation | _____ |
| <input type="checkbox"/> Communications | <input type="checkbox"/> Music | | _____ |
| <input checked="" type="checkbox"/> Conservation | | | _____ |

STATEMENT OF SIGNIFICANCE

After the completion of Akron's Cascade Mill Race in the 1830's, Dr. Eliakim Crosby began surveys which revealed that with the adequate right-of-way, territory and construction funds, a water power second in magnitude and accessibility to no other in the western country could be created. Plans for a new manufacturing town were begun - 200 of the 2500 acres acquired were platted as Summit City in the area presently designated as the North Hill area of Akron. Capitalists from the East were invited to invest in manufacturing, business and private lots. On February 27, 1837, a charter was granted to the Portage Canal and Manufacturing Company with authorization to sell bonds for the purpose of constructing a dam and canal, the purpose of which was to provide water power for the manufacturing developments in "Summit City". This project was to be called Chuckery Race, to be 4 miles in length.

Because of the severe topography of the area, and the sheer magnitude of the Chuckery project, numerous engineering difficulties had to be overcome. The Chuckery Race began at a dam, located in a gorge. Dam construction was completed in 1843. For two miles south of the dam, The Chuckery Race was either cut from solid rock or built up with rock and stone; it continued south, leaving the gorge, to the upper plateau of "Summit City" which was nearly 100 feet above the gorge. On May 27, 1844, the project was practically completed; the gates were opened, allowing the water to flow through the full four miles of the Chuckery Race. More work was still necessary, but never completed due to disharmony among the stockholders, legal problems, and lack of funds. Further, the location of the county seat in Akron led to the collapse of "Summit City".

The High Glens Park was constructed in Cuyahoga Falls in 1882. This park, encompassing the gorge, provided a setting which was duplicated nowhere else in Ohio. Various features included dining facilities, dance hall, roller coaster (credited as the first in the country), croquet, pedestrian suspension bridges, ferry boat, caves and treehouses. One of the most prominent features of the park was the main walkway through and along the Chuckery Race, called the "Grande Promenade" which utilized the rock wall and bed of the Chuckery Race. Various sitting, picnic and planted areas were developed along it. There are presently plans to reconstruct this park site.

SEE INSTRUCTIONS

9. MAJOR BIBLIOGRAPHICAL REFERENCES

Fairchild, Rev. T.B., A History of the Town of Cuyahoga Falls, 1876.
 Lane, Samuel A., Fifty Years and Over of Akron and Summit County, 1887.
 Perrin, Willian Henry, History of Summit County, 1881.

10. GEOGRAPHICAL DATA

| LATITUDE AND LONGITUDE COORDINATES DEFINING A RECTANGLE LOCATING THE PROPERTY | | | O R | LATITUDE AND LONGITUDE COORDINATES DEFINING THE CENTER POINT OF A PROPERTY OF LESS THAN TEN ACRES | | |
|--|--------------------------|-------------------------|--------|---|-----------|---------|
| CORNER | LATITUDE | LONGITUDE | | LATITUDE | LONGITUDE | |
| | Degrees Minutes Seconds | Degrees Minutes Seconds | | Degrees | Minutes | Seconds |
| NW | ° ' " | ° ' " | | ° | ' | " |
| NE | ° ' " | ° ' " | | ° | ' | " |
| SE | (see continuation sheet) | | | ° | ' | " |
| SW | ° ' " | ° ' " | | ° | ' | " |

APPROXIMATE ACREAGE OF NOMINATED PROPERTY: (see continuation sheet)

LIST ALL STATES AND COUNTIES FOR PROPERTIES OVERLAPPING STATE OR COUNTY BOUNDARIES

| STATE: | CODE | COUNTY | CODE |
|--------|------|---------|------|
| | | | |
| STATE: | CODE | COUNTY: | CODE |
| | | | |
| STATE: | CODE | COUNTY: | CODE |
| | | | |
| STATE: | CODE | COUNTY: | CODE |
| | | | |

11. FORM PREPARED BY

NAME AND TITLE: William R. Coleman, Mayor & John R. Daily, Director-Secretary
 ORGANIZATION: City of Cuyahoga Falls Akron Metropolitan Park District DATE: March 28, 1972
 STREET AND NUMBER: 2310 Second St. 2077 Newton St. (Akron, Ohio)
 CITY OR TOWN: Cuyahoga Falls STATE: Ohio CODE: 039

12. STATE LIAISON OFFICER CERTIFICATION

As the designated State Liaison Officer for the National Historic Preservation Act of 1966 (Public Law 89-665), I hereby nominate this property for inclusion in the National Register and certify that it has been evaluated according to the criteria and procedures set forth by the National Park Service. The recommended level of significance of this nomination is:

National State Local

Name _____

Title _____

Date _____

NATIONAL REGISTER VERIFICATION

I hereby certify that this property is included in the National Register.

 Chief, Office of Archeology and Historic Preservation

Date _____

ATTEST:

 Keeper of The National Register

Date _____

SEE INSTRUCTIONS

NATIONAL REGISTER OF HISTORIC PLACES
INVENTORY - NOMINATION FORM

(Continuation Sheet)

| | | |
|------------------|--------|------|
| STATE | Ohio | |
| COUNTY | Summit | |
| FOR NPS USE ONLY | | |
| ENTRY NUMBER | | DATE |
| | | |

(Number all entries)

Chuckery Race (Gorge Metropolitan Park)

2. Location

Northern (stone wall) section: 30 feet wide and approximately 3,900 feet long, located to the east of the east wall of the Cuyahoga River Gorge, in the city of Cuyahoga Falls.

Southern (earth fill & excavation) section: approximately 16,000 feet long, located south of the southern wall of the Cuyahoga River Gorge, in and south of the city of Cuyahoga Falls.

10. Geographical Data

Northern (stone wall) section: latitude: NW 41° 07' 42"
 NE 41° 07' 38"
 SE 41° 07' 13"
 SW 41° 07' 16"

longitude:
 NW 81° 29' 00"
 NE 81° 29' 7.5"
 SE 81° 29' 29"
 SW 81° 29' 27"

Southern (earth fill & excavation) section:
 latitude: NW 41° 07' 10"
 NE 41° 07' 32"
 SE 41° 07' 02"
 SW 41° 07' 42"

longitude:
 NW 81° 31' 38"
 NE 81° 29' 51"
 SE 81° 29' 27"
 SW 81° 31' 27.5"

11. Approximate acreage of nominated property

Northern (stone wall) section: 8.5 acres
Southern (earth fill & excavation) section: 36.5 acres

**NATIONAL REGISTER OF HISTORIC PLACES
PROPERTY PHOTOGRAPH FORM**

(Type all entries - attach to or enclose with photograph)

| | |
|------------------|------|
| STATE Ohio | |
| COUNTY Summit | |
| FOR NPS USE ONLY | |
| ENTRY NUMBER | DATE |
| | |

SEE INSTRUCTIONS

| | | | |
|--|-------------|-------------------|-------------|
| 1. NAME | | | |
| COMMON: Chuckery Race (Gorge Metropolitan Park) | | | |
| AND/OR HISTORIC: | | | |
| 2. LOCATION | | | |
| STREET AND NUMBER: (see continuation sheet) | | | |
| CITY OR TOWN: Cuyahoga Falls | | | |
| STATE: Ohio | CODE 039 | COUNTY: Summit | CODE 153 |
| 3. PHOTO REFERENCE | | | |
| PHOTO CREDIT: Dept. of Industrial & Community Development | | | |
| DATE OF PHOTO: Oct. 1972 | | | |
| NEGATIVE FILED AT: Dept. of Industrial & Community Development, Cuyahoga Falls, Ohio | | | |
| 4. IDENTIFICATION | | | |
| DESCRIBE VIEW, DIRECTION, ETC. Mid point of southern (earth fill & excavation) portion of Chuckery Race taken from bed of the Chuckery looking northeast. | | | |

INT: 154-72

**NATIONAL REGISTER OF HISTORIC PLACES
PROPERTY PHOTOGRAPH FORM**

(Type all entries - attach to or enclose with photograph)

| | |
|------------------|------|
| STATE Ohio | |
| COUNTY Summit | |
| FOR NPS USE ONLY | |
| ENTRY NUMBER | DATE |
| | |

SEE INSTRUCTIONS

| | | | |
|--|-------------|-------------------|-------------|
| 1. NAME | | | |
| COMMON: Chuckery Race (Gorge Metropolitan Park) | | | |
| AND/OR HISTORIC: | | | |
| 2. LOCATION | | | |
| STREET AND NUMBER: (see continuation sheet) | | | |
| CITY OR TOWN: Cuyahoga Falls | | | |
| STATE: Ohio | CODE 039 | COUNTY: Summit | CODE 153 |
| 3. PHOTO REFERENCE | | | |
| PHOTO CREDIT: Dept. of Industrial and Community Development | | | |
| DATE OF PHOTO: Oct. 30, 1972 | | | |
| NEGATIVE FILED AT: Dept. of Industrial and Community Development, Cuyahoga Falls, Ohio | | | |
| 4. IDENTIFICATION | | | |
| DESCRIBE VIEW, DIRECTION, ETC. Middle portion of Chuckery Race stone wall. The photograph was taken at the water line of the Cuyahoga River, looking south. | | | |

INT: 154-72

**NATIONAL REGISTER OF HISTORIC PLACES
PROPERTY PHOTOGRAPH FORM**

(Type all entries - attach to or enclose with photograph)

| | |
|------------------|------|
| STATE Ohio | |
| COUNTY Summit | |
| FOR NPS USE ONLY | |
| ENTRY NUMBER | DATE |
| | |

SEE INSTRUCTIONS

| | | | |
|--|-------------|-------------------|-------------|
| 1. NAME | | | |
| COMMON: Chuckery Race (Gorge Metropolitan Park) | | | |
| AND/OR HISTORIC: | | | |
| 2. LOCATION | | | |
| STREET AND NUMBER: (see continuation sheet) | | | |
| CITY OR TOWN: Cuyahoga Falls | | | |
| STATE: Ohio | CODE 039 | COUNTY: Summit | CODE 153 |
| 3. PHOTO REFERENCE | | | |
| PHOTO CREDIT: Dept. of Industrial & Community Development | | | |
| DATE OF PHOTO: Oct. 1972 | | | |
| NEGATIVE FILED AT: Dept. of Industrial & Community Development, Cuyahoga Falls, Ohio | | | |
| 4. IDENTIFICATION | | | |
| DESCRIBE VIEW, DIRECTION, ETC. Northern (stone wall) section, north portion of the wall. Photo taken from the top of the Chuckery wall looking north. | | | |

INT: 154-72

**NATIONAL REGISTER OF HISTORIC PLACES
PROPERTY PHOTOGRAPH FORM**

(Type all entries - attach to or enclose with photograph)

| | |
|------------------|------|
| STATE Ohio | |
| COUNTY Summit | |
| FOR NPS USE ONLY | |
| ENTRY NUMBER | DATE |
| | |

SEE INSTRUCTIONS

| | | | |
|---|-------------|-------------------|-------------|
| 1. NAME | | | |
| COMMON: Chuckery Race (Gorge Metropolitan Park) | | | |
| AND/OR HISTORIC: | | | |
| 2. LOCATION | | | |
| STREET AND NUMBER: (see continuation sheet) | | | |
| CITY OR TOWN: Cuyahoga Falls | | | |
| STATE: Ohio | CODE 039 | COUNTY: Summit | CODE 153 |
| 3. PHOTO REFERENCE | | | |
| PHOTO CREDIT: Dept. of Industrial and Community Development | | | |
| DATE OF PHOTO: Oct. 30, 1972 | | | |
| NEGATIVE FILED AT: Dept. of Industrial and Community Development, Cuyahoga Falls, Ohio | | | |
| 4. IDENTIFICATION | | | |
| DESCRIBE VIEW, DIRECTION, ETC. Photograph taken from the top of the Chuckery Race stone wall looking south. The Cuyahoga River is to the right and Chuckery Race bed is to the left. | | | |

INT: 154-72

| | |
|------------------|------|
| STATE Ohio | |
| COUNTY Summit | |
| FOR NPS USE ONLY | |
| ENTRY NUMBER | DATE |
| | |

NATIONAL REGISTER OF HISTORIC PLACES
PROPERTY MAP FORM

(Type all entries - attach to or enclose with map)

SEE INSTRUCTIONS

| | | | |
|--|-------------|-------------------|-------------|
| 1. NAME | | | |
| COMMON: Chuckery Race (Gorge Metropolitan Park) | | | |
| AND/OR HISTORIC: | | | |
| 2. LOCATION | | | |
| STREET AND NUMBER: (see continuation sheet) | | | |
| CITY OR TOWN: Cuyahoga Falls | | | |
| STATE: Ohio | CODE 039 | COUNTY: Summit | CODE 153 |
| 3. MAP REFERENCE | | | |
| SOURCE: U.S.G.S. Akron West Quadrangle | | | |
| SCALE: 1:24000 | | | |
| DATE: 1963 revised 1970 | | | |
| 4. REQUIREMENTS | | | |
| TO BE INCLUDED ON ALL MAPS | | | |
| <ol style="list-style-type: none"> Property boundaries where required. North arrow. Latitude and longitude reference. | | | |

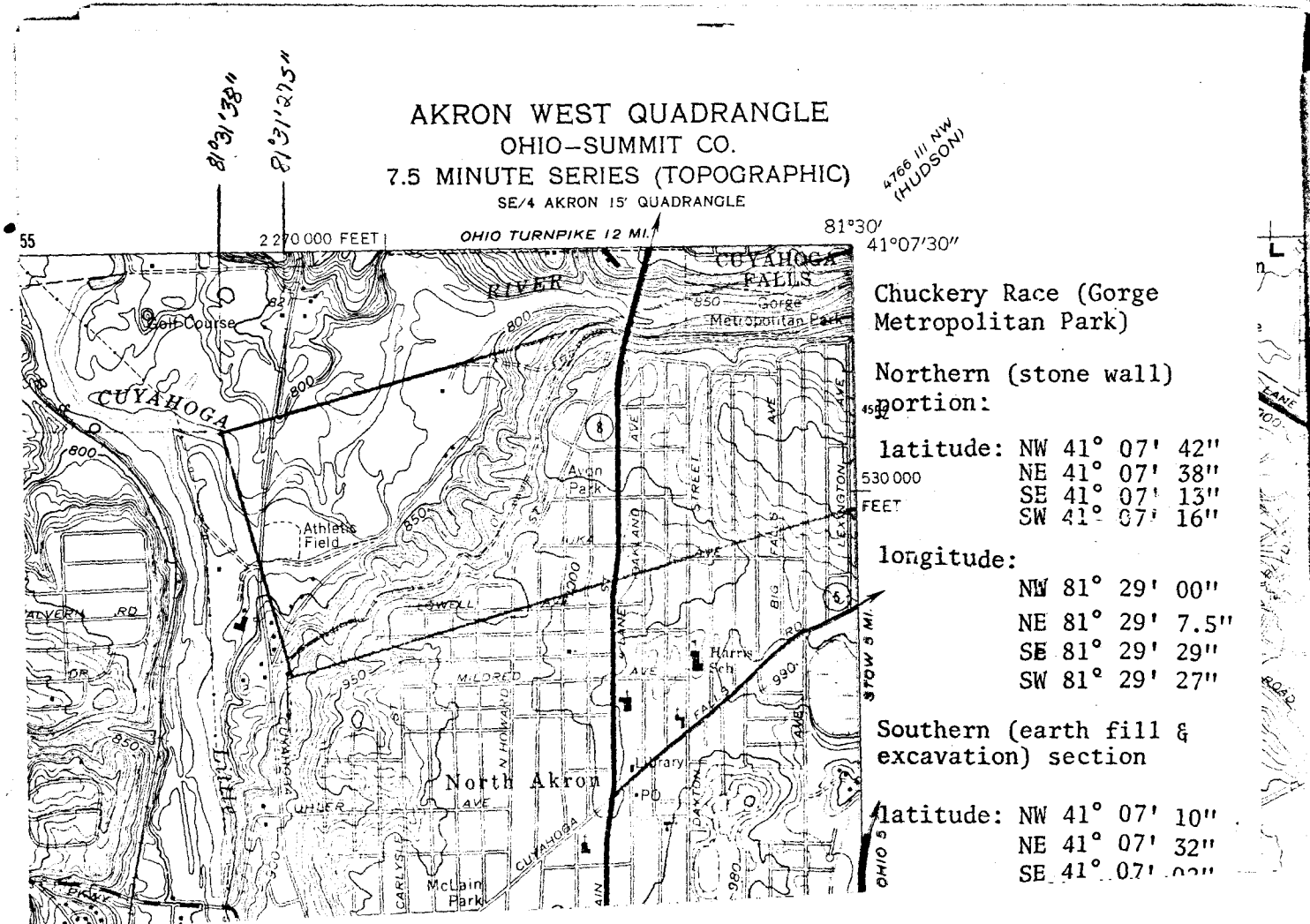

NATIONAL REGISTER OF HISTORIC PLACES
PROPERTY MAP FORM

(Type all entries - attach to or enclose with map)

| | |
|------------------|------|
| STATE Ohio | |
| COUNTY Summit | |
| FOR NPS USE ONLY | |
| ENTRY NUMBER | DATE |
| | |

SEE INSTRUCTIONS

| | | | |
|---|-------------|-------------------|-------------|
| 1. NAME | | | |
| COMMON: Chuckery Race (Gorge Metropolitan Park) | | | |
| AND/OR HISTORIC: | | | |
| 2. LOCATION | | | |
| STREET AND NUMBER: (see continuation sheet) | | | |
| CITY OR TOWN: Cuyahoga Falls | | | |
| STATE: Ohio | CODE 039 | COUNTY: Summit | CODE 153 |
| 3. MAP REFERENCE | | | |
| SOURCE: U.S.G.S. Akron East Quadrangle | | | |
| SCALE: 1:24000 | | | |
| DATE: 1963 revised 1970 | | | |
| 4. REQUIREMENTS | | | |
| TO BE INCLUDED ON ALL MAPS | | | |
| 1. Property boundaries where required. | | | |
| 2. North arrow. | | | |
| 3. Latitude and longitude reference. | | | |

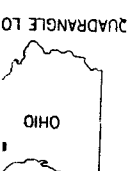

UNITED STATES
DEPARTMENT OF THE INTERIOR
GEOLOGICAL SURVEY

466 11 NE (PENINSULA)
81°30' R. 11 W. 459000m E. KENT 7 MI. SILVER LAKE 3.4 MI. R. 10 W. 1 MI. TO OHIO 5
41°07'30"

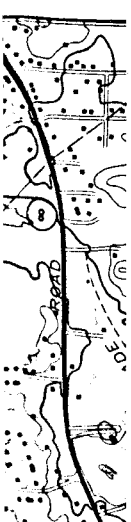
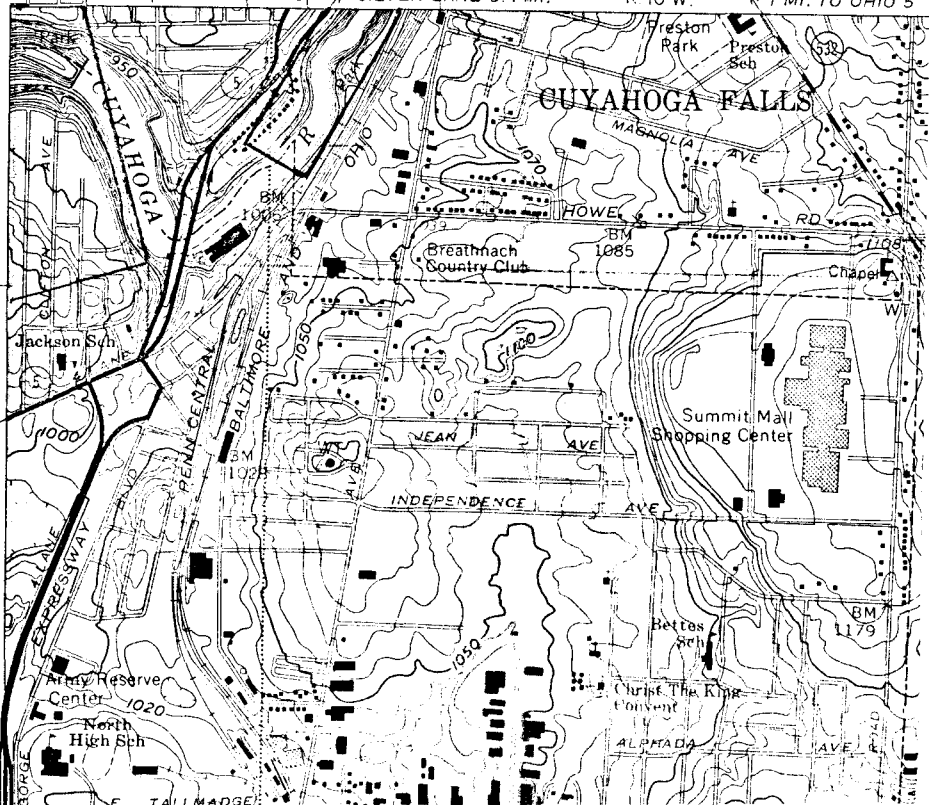

**NATIONAL REGISTER OF HISTORIC PLACES
PROPERTY MAP FORM**

(Type all entries - attach to or enclose with map)

| | |
|------------------|------|
| STATE Ohio | |
| COUNTY Summit | |
| FOR NPS USE ONLY | |
| ENTRY NUMBER | DATE |

SEE INSTRUCTIONS

| | | | |
|--|-------------|-------------------|-------------|
| 1. NAME | | | |
| COMMON: Chuckery Race (Gorge Metropolitan Park) | | | |
| AND/OR HISTORIC: | | | |
| 2. LOCATION | | | |
| STREET AND NUMBER: (see continuation sheet) | | | |
| CITY OR TOWN: Cuyahoga Falls | | | |
| STATE: Ohio | CODE 039 | COUNTY: Summit | CODE 153 |
| 3. MAP REFERENCE | | | |
| SOURCE: U.S.G.S. Hudson Quadrangle | | | |
| SCALE: 1:24000 | | | |
| DATE: 1963 revised 1970 | | | |
| 4. REQUIREMENTS | | | |
| TO BE INCLUDED ON ALL MAPS | | | |
| <ol style="list-style-type: none"> Property boundaries where required. North arrow. Latitude and longitude reference. | | | |

NW 81° 31' 38"
NE 81° 29' 51"
SE 81° 29' 27"
SW 81° 31' 27.5"

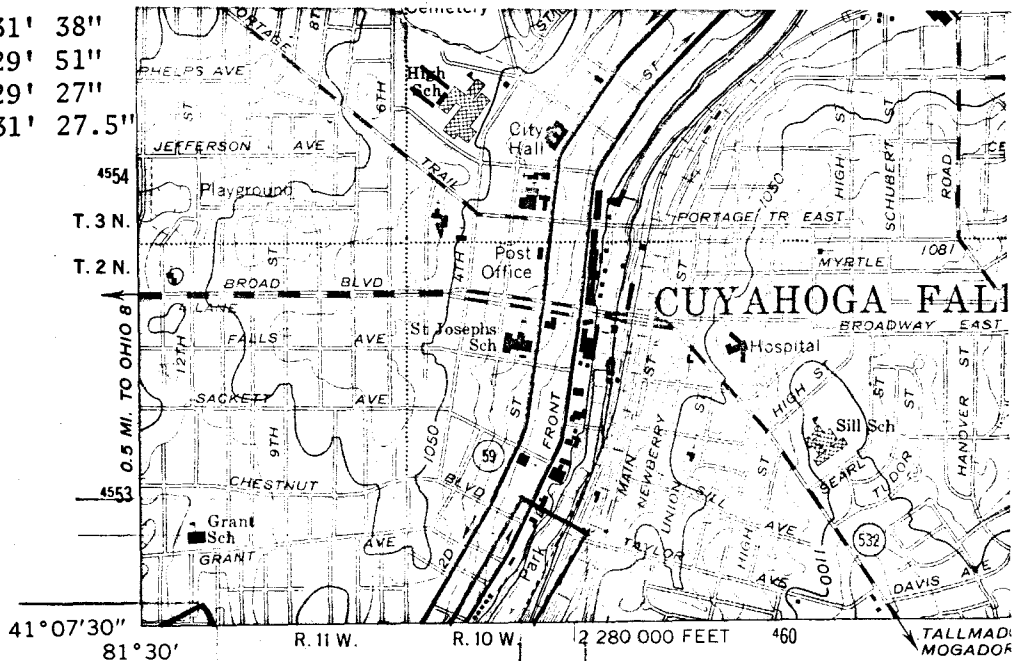

(AKRON WEST)
4,686 11 SE

Mapped, edited, and published by the Geological Survey
Revised in cooperation with State of Ohio agencies
Control by USGS and USC&GS

Topography by photogrammetric methods from aerial photographs
taken 1952 and planetable surveys 1953. Revised from aerial
photographs taken 1962. Field checked 1963

Polyconic projection. 1927 North American datum
10,000-foot grid based on Ohio coordinate system, north zone
1000-meter Universal Transverse Mercator grid ticks, zone 17, shown in blue

Fine red dashed lines indicate selected fence and field lines where
generally visible on aerial photographs. This information is unchecked

Red tint indicates areas in which only landmark buildings are shown

UTM GRI
DECLIN

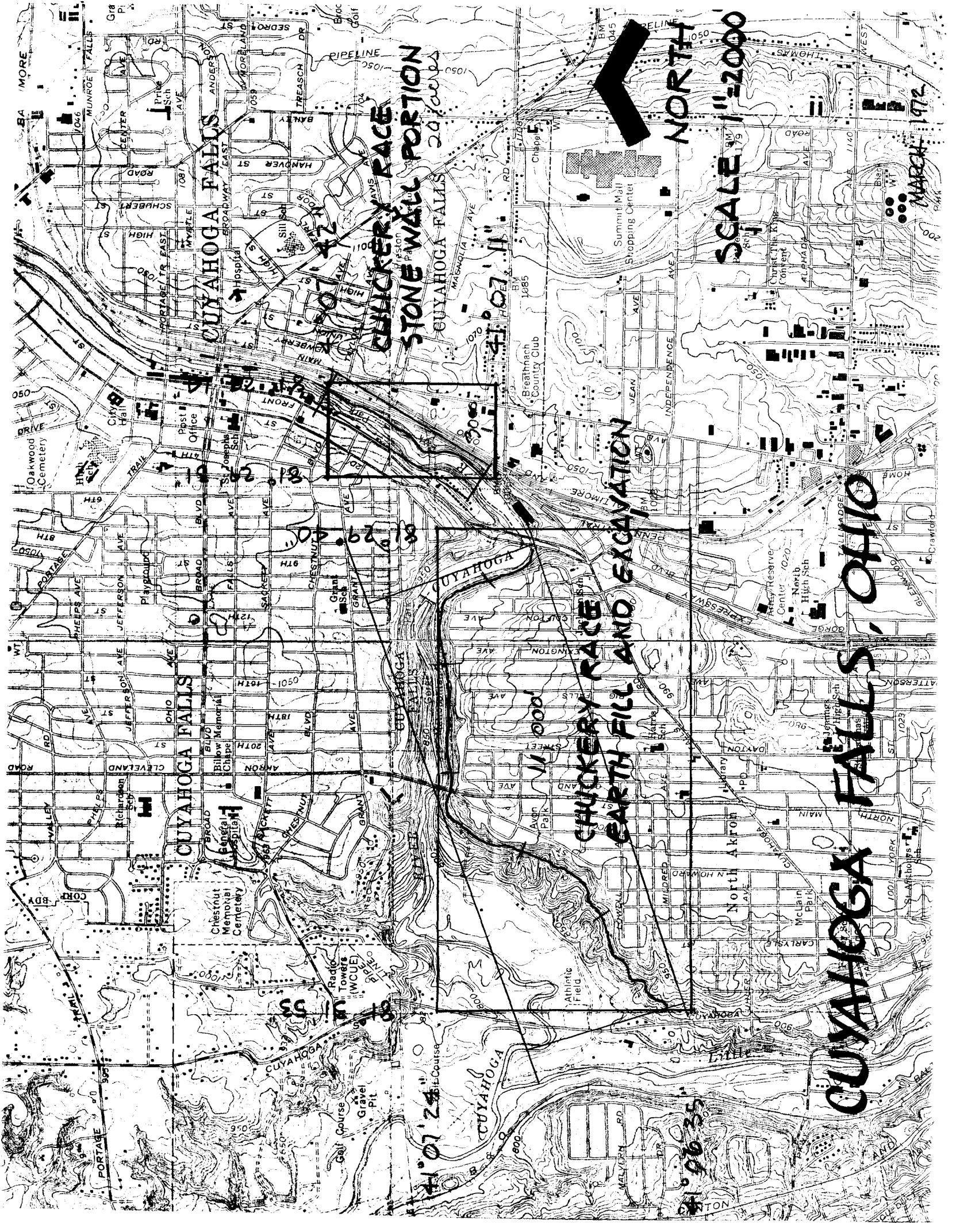

CUYAHOGA FALLS

CUYAHOGA FALLS

CUYAHOGA FALLS, OHIO

CHUCKERY RACE
STONE WALL PORTION
CUYAHOGA FALLS 20' across

CHUCKERY RACE
EARTH FILL AND EXCAVATION

NORTH

SCALE 1"=2000'

41° 07' 24"

41° 07' 11"

41° 06' 35"

MARCH 1972

January 2, 1973

Mr. William R. Coleman, Mayor
City of Cuyahoga Falls
2310 Second Street
Cuyahoga Falls, Ohio 44221

Dear Mr. Coleman:

I am pleased to inform you that Chuckery Race has been entered in the National Register of Historic Places by the National Park Service, United States Department of Interior.

The nomination was made in connection with a state plan to identify and document prehistoric and historic places in Ohio which qualify for National Register status under provisions of the National Historic Preservation Act of 1966. All nominations are approved by the Ohio Historic Site Preservation Advisory Board.

Enclosed is a brochure explaining the purposes and goals of the National Register of Historic Places.

Congratulations for recognizing the importance of, and the need for, the careful and sensible preservation of Ohio's landmarks. Your farsightedness will surely serve as an example to other individuals and organizations in this state.

Sincerely,

Judith Kitchen
Architectural Historian

JK/glk
enclosure

Ohio Historic Preservation Office

National Register of Historic Places File Checklist

The following materials are contained in this file of the National Register form for:

Name: Chuckery Race

County: Summit

Original National Register of Historic Places nomination form

Multiple Property Nomination form

Photograph(s)

Photograph(s) (copies)

USGS map(s)

USGS map(s) (copies)

Sketch map(s)/figure(s)/exhibit(s)

Correspondence

Other news clips, Cuyahoga Falls city map
