

Ref# 7300139

NATIONAL REGISTER OF HISTORIC PLACES
INVENTORY - NOMINATION FORM

(Type all entries - complete applicable sections)

STATE:	Ohio
COUNTY:	Summit
FOR NPS USE ONLY	
ENTRY DATE	5-22-73

1. NAME

COMMON:
Barber, O. C., Creamery

AND/OR HISTORIC:

2. LOCATION

STREET AND NUMBER:
365 Portsmouth Avenue

CITY OR TOWN:
Barberton

CONGRESSIONAL DISTRICT:
14

STATE:
Ohio

CODE:
039

COUNTY:
Summit

CODE:
153

John F. Seiberling, Jr.

3. CLASSIFICATION

CATEGORY (Check One)	OWNERSHIP	STATUS	ACCESSIBLE TO THE PUBLIC
<input type="checkbox"/> District <input type="checkbox"/> Site <input type="checkbox"/> Object <input checked="" type="checkbox"/> Building <input type="checkbox"/> Structure 	<input type="checkbox"/> Public <input checked="" type="checkbox"/> Private <input type="checkbox"/> Both 	<input checked="" type="checkbox"/> Occupied <input type="checkbox"/> Unoccupied <input type="checkbox"/> Preservation work in progress 	Yes: <input type="checkbox"/> Restricted <input type="checkbox"/> Unrestricted <input checked="" type="checkbox"/> No
PRESENT USE (Check One or More as Appropriate)			
<input type="checkbox"/> Agricultural <input type="checkbox"/> Commercial <input type="checkbox"/> Educational <input type="checkbox"/> Entertainment 	<input type="checkbox"/> Government <input type="checkbox"/> Industrial <input type="checkbox"/> Military <input type="checkbox"/> Museum 	<input type="checkbox"/> Park <input checked="" type="checkbox"/> Private Residence <input type="checkbox"/> Religious <input type="checkbox"/> Scientific 	<input type="checkbox"/> Transportation <input type="checkbox"/> Other (Specify) _____ _____

4. OWNER OF PROPERTY

OWNER'S NAME:
Mrs. Paul Pamer

STREET AND NUMBER:
365 Portsmouth Avenue

CITY OR TOWN:
Barberton

STATE:
Ohio

CODE:
44203

CODE:
039

5. LOCATION OF LEGAL DESCRIPTION

COURTHOUSE, REGISTRY OF DEEDS, ETC.:
Summit County Courthouse

STREET AND NUMBER:
209 South High Street

CITY OR TOWN:
Akron

STATE:
Ohio

CODE:
039

6. REPRESENTATION IN EXISTING SURVEYS

TITLE OF SURVEY:

DATE OF SURVEY: Federal State County Local

DEPOSITORY FOR SURVEY RECORDS:

STREET AND NUMBER:

CITY OR TOWN:

STATE:

CODE:

SEE INSTRUCTIONS

STATE:	Ohio
COUNTY:	Summit
ENTRY NUMBER	
DATE	

FOR NPS USE ONLY

7. DESCRIPTION

CONDITION	(Check One)					
	<input checked="" type="checkbox"/> Excellent	<input type="checkbox"/> Good	<input type="checkbox"/> Fair	<input type="checkbox"/> Deteriorated	<input type="checkbox"/> Ruins	<input type="checkbox"/> Unexposed
	(Check One)			(Check One)		
	<input type="checkbox"/> Altered	<input checked="" type="checkbox"/> Unaltered		<input type="checkbox"/> Moved	<input checked="" type="checkbox"/> Original Site	

DESCRIBE THE PRESENT AND ORIGINAL (if known) PHYSICAL APPEARANCE

The O. C. Barber Creamery is located approximately 200 feet east of Barn No. 1. The concrete datestone on the south end of the building clearly attests to its former owner and present age, as it reads "O. C. B. 1909".

The Creamery is best described as having a long rectangular section running east to west with a smaller square section attached to the southwest side of the building. It is this square section that housed the dairykeeper and his family. The long rectangular section of the Creamery contains two rooms. The room in the east section of the Creamery was used for bottling, while the room in the west section of the Creamery was used for distribution. On the extreme west side of this section were large doors through which both milk trucks and milk wagons were loaded.

The Creamery is, like all of the other Anna Dean Farm buildings, made of brick and trimmed with concrete block. Mr. Barber had a great eye for symmetry and beauty and the Creamery was the only building in which different shades of red brick were used. Probably not pleased with the effect, Barber built the other Anna Dean Farm buildings using only red brick. The living quarters of the Creamery have 12 rooms on two floors. Entrance to the rest of the Creamery cannot be made through these living quarters.

The two dairy rooms are both one story high and are connected by a large set of interior doors. The dairy section of the Creamery has rather large unusual outside windows. These windows, about 8 feet high, are actually three separate sets of windows mounted on different tracks. Any or all of these three sections could be opened to provide a breeze to cool off the Creamery and, even though there was electricity in the Creamery, these windows provided for natural lighting.

The basement for the Creamery extends only under the living quarters. The basement is odd because it is on three individual levels. The dairy section of the Creamery is built on a slab.

The roof of the Creamery is the hip style roof and the entire roof is covered with red tiles. There are two dormers on the east side of the roof above the living quarters. This building was the second and last building to have wooden overhangs. All the Barber buildings after the Creamery had concrete dentil work instead of overhangs. On the north side of the roof above the living quarters is a skylight that emits sunshine into a second story bathroom. Also on this side of the roof is a brick chimney that is connected to the furnace.

SEE INSTRUCTIONS

8. SIGNIFICANCE

PERIOD (Check One or More as Appropriate)

- Pre-Columbian 16th Century 18th Century 20th Century
 15th Century 17th Century 19th Century

SPECIFIC DATE(S) (If Applicable and Known) 1909

AREAS OF SIGNIFICANCE (Check One or More as Appropriate)

- | | | | |
|--|---|--|--|
| <input type="checkbox"/> Aboriginal | <input type="checkbox"/> Education | <input type="checkbox"/> Political | <input type="checkbox"/> Urban Planning |
| <input type="checkbox"/> Prehistoric | <input type="checkbox"/> Engineering | <input type="checkbox"/> Religion/Philosophy | <input type="checkbox"/> Other (Specify) |
| <input type="checkbox"/> Historic | <input type="checkbox"/> Industry | <input type="checkbox"/> Science | _____ |
| <input checked="" type="checkbox"/> Agriculture | <input type="checkbox"/> Invention | <input type="checkbox"/> Sculpture | _____ |
| <input checked="" type="checkbox"/> Architecture | <input type="checkbox"/> Landscape Architecture | <input type="checkbox"/> Social/Humanitarian | _____ |
| <input type="checkbox"/> Art | <input type="checkbox"/> Literature | <input type="checkbox"/> Theater | _____ |
| <input type="checkbox"/> Commerce | <input type="checkbox"/> Military | <input type="checkbox"/> Transportation | _____ |
| <input type="checkbox"/> Communications | <input type="checkbox"/> Music | | _____ |
| <input type="checkbox"/> Conservation | | | _____ |

STATEMENT OF SIGNIFICANCE

The Creamery was the second Anna Dean Farm building to be completed by Ohio Columbus Barber.

In 1890, O. C. Barber, head of the Akron based Diamond Match Company, was sued by the city of Akron for over \$163,000 in back taxes. Barber had ignored the city tax, as he paid a penny federal tax on each 100 matches he made, which amounted to over \$600,000 annually.

Outraged over the suit, Barber decided to move his match company and its subsidiaries to some land he owned near New Portage. With the backing of John Robinson, George Crouse, and Colonel George T. Perkins, Barber purchased more land and had Michael Alexander lay out a town for him. Barber named the new town Barberton, in honor of himself, and called the city's natural lake, Anna, after his daughter.

By 1894 Barber's business interests had abandoned Akron and Barber decided that he would like to do the same. Barber called in Michael Alexander and had him lay out a farm for him on 2,000 southeast of Barberton. Construction began on the Anna Dean Farm in 1905 and the first building, Barn No. 1 was completed in 1909. Barn No. 1 was followed a few months later by the Creamery.

When the Anna Dean Farm was completed, there were twenty-three buildings in all, including a forty room mansion and twelve acres of green house space. Barber was a great advocate of scientific farming. He believed that the produce from his farm would soon make it self-sufficient. In keeping with his beliefs of scientific farming, he purchased steam tractors, incubators, trucks, and a wide assortment of gadgets that cost ten times their worth.

The only Anna Dean enterprise to ever turn a profit was the Creamery. Opened in 1909, it was the longest-running Anna Dean enterprise. Barber insisted that his Creamery be mechanized.

In the East room of the Creamery the milk, taken from Barber's 1,000 head of prize dairy cattle which (continued)

SEE INSTRUCTIONS

A

B

C

NATIONAL REGISTER OF HISTORIC PLACES
INVENTORY - NOMINATION FORM

(Continuation Sheet)

STATE		Ohio
COUNTY		Summit
FOR NPS USE ONLY		
ENTRY NUMBER	DATE	

(Number all entries)

Barber, O. C. Creamery

7. Description

The Creamery is in excellent condition inside and outside. It has received great care and does not show its age of 64 years.

8. Significance

he insisted be periodically vacuumed) was poured into a large holding vat. A conveyor moved the milk bottles past the nozzle of the vat, where the bottles were stopped and filled. The conveyor belt then moved them to workers who capped them and sent them on their way. When a bottle reached the end of the line it was in the distribution room where it was placed on a milk wagon or truck. Barber's milk was bottled in quarts and pints with the cream in 1/2 pints.

When Barber died, in 1920, Western Reserve College turned down his bequeathal of the Anna Dean Farm. It was then split up and sold. The Creamery was sold to the Telling Belle Vernon Company who ran it as a dairy. Later the Creamery was used as a clubhouse for the Anna Dean Golf Course, after which it was sold, along with Barn No. 1, to its present owner.

On March 27, 1973, the O.C. Barber Carriage House and Apiary were torn down to prevent the city of Barberton from completing their purchase of this land as a park site. They join the Barber Mansion and other farm buildings that were destroyed for short time gains.

Recently the owners of Barn No. 1 and the Creamery were asked to sell their land, razing Barn No. 1 for a senior citizen apartment under the FHA 236 Program. The owner now threatens to have both barn and creamery destroyed. Barn No. 1 was recently placed on the National Register of Historic Places. It is hoped that the Creamery and other remaining O.C. Barber buildings can also gain this honor. The buildings, once part of a single 2000 acre farm, are now quite separate with roads, playing fields, apartments, etc. between them.

9. MAJOR BIBLIOGRAPHICAL REFERENCES

Arter, William, "Ohio Columbus Barber", Columbus Dispatch, Oct. 13, 1963.
 Davis, William, The Story of Barberton, Ohio, 1890 - 1962, Barberton Public Library, 1963.
 Freudenheim, Milt, "They Still Gasp Over O. C. Barber, the Man Who Started a City", Akron Beacon Journal, 1951.

10. GEOGRAPHICAL DATA

LATITUDE AND LONGITUDE COORDINATES DEFINING A RECTANGLE LOCATING THE PROPERTY				O R	LATITUDE AND LONGITUDE COORDINATES DEFINING THE CENTER POINT OF A PROPERTY OF LESS THAN TEN ACRES							
CORNER	LATITUDE				LONGITUDE			LATITUDE			LONGITUDE	
	Degrees	Minutes	Seconds	Degrees	Minutes	Seconds	Degrees	Minutes	Seconds	Degrees	Minutes	Seconds
NW	°	'	"	°	'	"	41	00	26	°	'	"
NE	°	'	"	°	'	"				81	35	30
SE	°	'	"	°	'	"						
SW	°	'	"	°	'	"						

APPROXIMATE ACREAGE OF NOMINATED PROPERTY: 6 acres

LIST ALL STATES AND COUNTIES FOR PROPERTIES OVERLAPPING STATE OR COUNTY BOUNDARIES

STATE:	CODE	COUNTY	CODE

11. FORM PREPARED BY

NAME AND TITLE:
Steve Kelleher

ORGANIZATION _____ DATE 4/73

STREET AND NUMBER:
706 Wisteria Dr.

CITY OR TOWN: Barberton STATE Ohio CODE 039

12. STATE LIAISON OFFICER CERTIFICATION

As the designated State Liaison Officer for the National Historic Preservation Act of 1966 (Public Law 89-665), I hereby nominate this property for inclusion in the National Register and certify that it has been evaluated according to the criteria and procedures set forth by the National Park Service. The recommended level of significance of this nomination is:

National State Local

Name _____

Title _____

Date _____

NATIONAL REGISTER VERIFICATION

I hereby certify that this property is included in the National Register.

 Director, Office of Archeology and Historic Preservation

Date _____

ATTEST:

 Keeper of The National Register

Date _____

SEE INSTRUCTIONS

UNITED STATES DEPARTMENT OF THE INTERIOR
NATIONAL PARK SERVICE
NATIONAL REGISTER OF HISTORIC PLACES
PROPERTY PHOTOGRAPH FORM
(Type all entries - attach to or enclose with photograph)

1. NAME		
COMMON	AND/OR HISTORIC	NUMERIC CODE (Assigned by NPS)
Barber, O. C., Creamery		
2. LOCATION		
STATE	COUNTY	TOWN
Ohio	Summit	Barberton
STREET AND NUMBER		
365 Portsmouth Avenue		
3. PHOTO REFERENCE		
PHOTO CREDIT	DATE	NEGATIVE FILED AT
Steve Kelleher	April 1973	706 Wisteria Dr., Barberton
4. IDENTIFICATION		
DESCRIBE VIEW, DIRECTION, ETC.		

View looking northwest, living quarters at left, bottling area at right.

UNITED STATES DEPARTMENT OF THE INTERIOR
NATIONAL PARK SERVICE
NATIONAL REGISTER OF HISTORIC PLACES
PROPERTY PHOTOGRAPH FORM
(Type all entries - attach to or enclose with photograph)

1. NAME		
COMMON	AND/OR HISTORIC	NUMERIC CODE (Assigned by NPS)
Barber, O. C., Creamery		
2. LOCATION		
STATE	COUNTY	TOWN
Ohio	Summit	Barberton
STREET AND NUMBER		
365 Portsmouth Avenue		
3. PHOTO REFERENCE		
PHOTO CREDIT	DATE	NEGATIVE FILED AT
Steve Kelleher	April 1973	706 Wisteria Dr., Barberton
4. IDENTIFICATION		
DESCRIBE VIEW, DIRECTION, ETC.		

View looking at south end of the Creamery containing the living quarters and at the southeast side of the Creamery bottling area.

NATIONAL REGISTER OF HISTORIC PLACES
PROPERTY PHOTOGRAPH FORM

(Type all entries - attach to or enclose with photograph)

1. NAME		
COMMON	AND/OR HISTORIC	NUMERIC CODE (Assigned by NPS)
Barber, O. C., Creamery		
2. LOCATION		
STATE	COUNTY	TOWN
Ohio	Summit	Barberton
STREET AND NUMBER		
365 Portsmouth Avenue		
3. PHOTO REFERENCE		
PHOTO CREDIT	DATE	NEGATIVE FILED AT
Robert Kamenar	April 1971	138 1st Street, Barberton
4. IDENTIFICATION		
DESCRIBE VIEW, DIRECTION, ETC.		

View looking northwest; barn #1 shows in background.

NATIONAL REGISTER OF HISTORIC PLACES
PROPERTY PHOTOGRAPH FORM

(Type all entries - attach to or enclose with photograph)

1. NAME		
COMMON	AND/OR HISTORIC	NUMERIC CODE (Assigned by NPS)
Barber, O. C., Creamery		
2. LOCATION		
STATE	COUNTY	TOWN
Ohio	Summit	Barberton
STREET AND NUMBER		
365 Portsmouth Avenue		
3. PHOTO REFERENCE		
PHOTO CREDIT	DATE	NEGATIVE FILED AT
Steve Kelleher	April 1973	706 Wisteria Dr., Barberton
4. IDENTIFICATION		
DESCRIBE VIEW, DIRECTION, ETC.		

The south end of the Creamery and the southwest side used for loading milk. On the southwest side notice the large loading doors and one of the large Creamery windows. On the living quarters the datestone under the semi-circular window is visible.

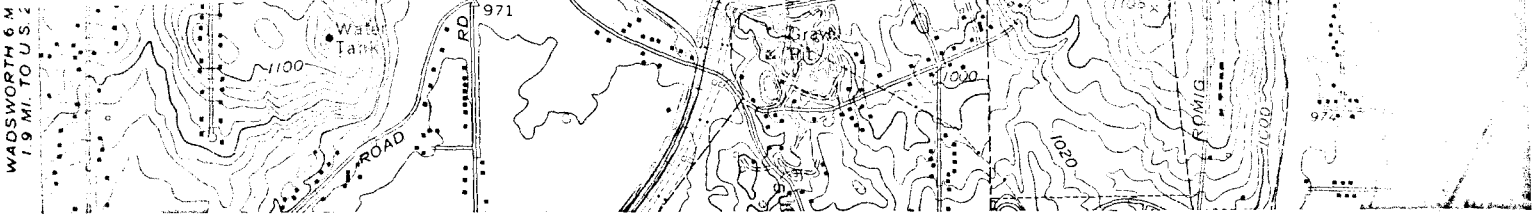

Form 10-301
(July 1969)

UNITED STATES DEPARTMENT OF THE INTERIOR
NATIONAL PARK SERVICE

**NATIONAL REGISTER OF HISTORIC PLACES
PROPERTY MAP FORM**

(Type all entries - attach to or enclose with map)

STATE Ohio	
COUNTY Summit	
FOR NPS USE ONLY	
ENTRY NUMBER	DATE

SEE INSTRUCTIONS

1. NAME			
COMMON:		Barber, O. C., Creamery	
AND/OR HISTORIC:			
2. LOCATION			
STREET AND NUMBER:			
365 Portsmouth Avenue			
CITY OR TOWN:			
Barberton			
STATE:	CODE	COUNTY:	CODE
Ohio	039	Summit	153
3. MAP REFERENCE			
SOURCE:			
U.S.G.S., 7.5' Akron West Quadrangle			
SCALE:			
1:24000			
DATE:			
1967			
4. REQUIREMENTS			
TO BE INCLUDED ON ALL MAPS			
<ol style="list-style-type: none"> Property boundaries where required. North arrow. Latitude and longitude reference. 			

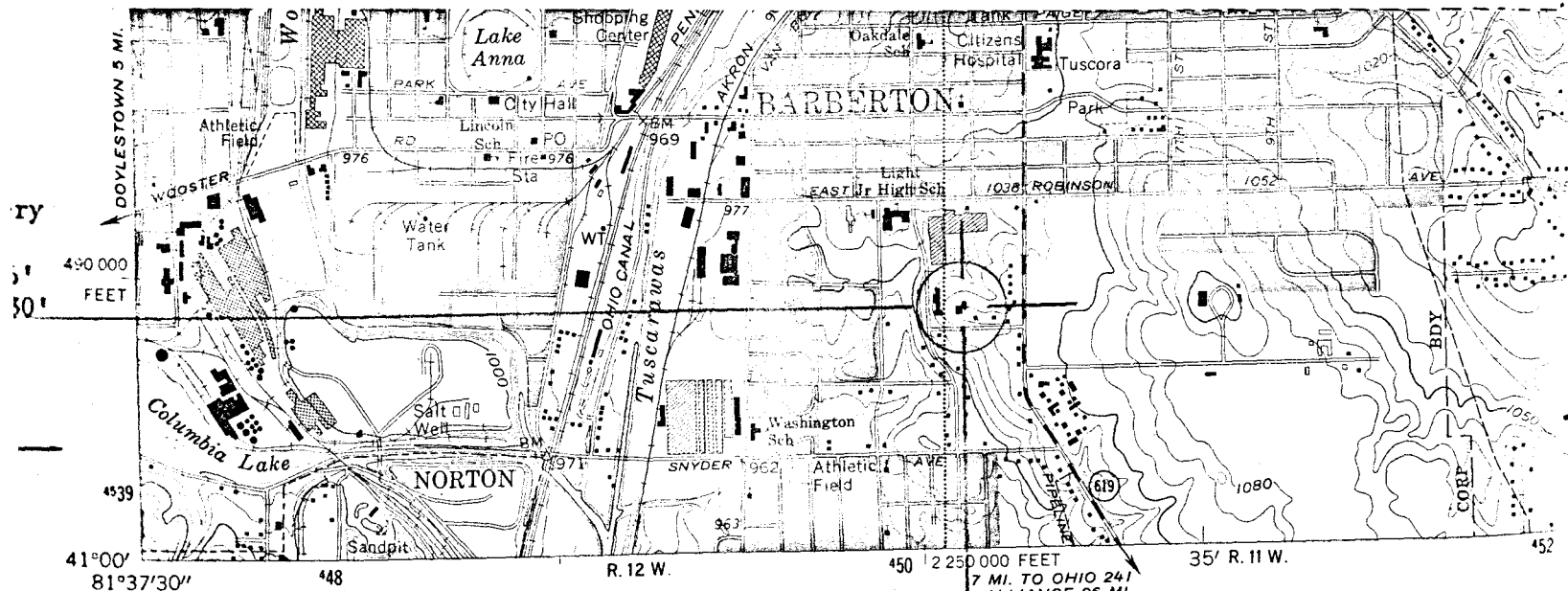

Mapped, edited, and published by the Geological Survey
Revised in cooperation with State of Ohio Agencies
Control by USGS and USC&GS

Topography by photogrammetric methods from aerial photographs
taken 1957. Field checked 1958. Revised from aerial
photographs taken 1966. Field checked 1967

Polyconic projection. 1927 North American datum
10,000-foot grid based on Ohio coordinate system, north zone
1000 meter UTM grid

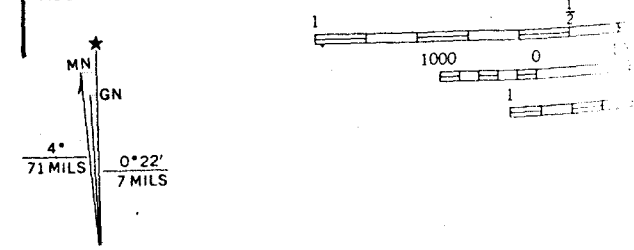

DOYLESTOWN 5 MI.

DOYLESTOWN 5 MI.

June 4, 1973

Mrs. Paul Pamer
365 Portsmouth Avenue
Barberton, Ohio

Dear Mrs. Pamer:

I am pleased to inform you that the O. C. Barber Creamery has been entered in the National Register of Historic Places by the National Park Service, United States Department of Interior.

The nomination was made in connection with a state plan to identify and document prehistoric and historic places in Ohio which qualify for National Register status under provisions of the National Historic Preservation Act of 1966. All nominations are approved by the Ohio Historic Site Preservation Advisory Board.

Enclosed is a brochure explaining the purposes and goals of the National Register of Historic Places.

Sincerely,

Judith Kitchen
Architectural Historian

JK/glk
enclosure

Ohio Historic Preservation Office

National Register of Historic Places File Checklist

The following materials are contained in this file of the National Register form for:

Name: Barber, OC, Creamery

County: Summit

Original National Register of Historic Places nomination form

Multiple Property Nomination form

Photograph(s)

Photograph(s) (copies)

USGS map(s)

USGS map(s) (copies)

Sketch map(s)/figure(s)/exhibit(s)

Correspondence

Other _____
