

NATIONAL REGISTER OF HISTORIC PLACES
REGISTRATION FORM

This form is for use in nominating or requesting determinations for individual properties and districts. See instructions in How to Complete the National Register of Historic Places Registration Form (National Register Bulletin 16A). Complete each item by marking "x" in the appropriate box or by entering the information requested. If any item does not apply to the property being documented, enter "N/A" for "not applicable." For functions, architectural classification, materials, and areas of significance, enter only categories and subcategories from the instructions. Place additional entries and narrative items on continuation sheets (NPS Form 10-900a). Use a typewriter, word processor, or computer, to complete all items.

1. Name of Property

historic name The Oakwood Cemetery Chapel

other names/site number N/A

2. Location

street & number 2420 Oakwood Drive not for publication
city or town Cuyahoga Falls vicinity N/A
state Ohio code 153 county Summit County zip code 44221

3. State/Federal Agency Certification

As the designated authority under the National Historic Preservation Act of 1986, as amended, I hereby certify that this X nomination ___ request for determination of eligibility meets the documentation standards for registering properties in the National Register of Historic Places and meets the procedural and professional requirements set forth in 36 CFR Part 60. In my opinion, the property X meets ___ does not meet the National Register Criteria. I recommend that this property be considered significant ___ nationally ___ statewide X locally. (___ See continuation sheet for additional comments.)

Barbara Pauer Dept. Head Inventory 9-27-99
planning Registration Date

Ohio Historic Preservation Office -- OH SHPO
State or Federal agency and bureau

In my opinion, the property ___ meets ___ does not meet the National Register criteria. (___ See continuation sheet for additional comments.)

Signature of commenting or other official Date

State or Federal agency and bureau

=====
6. Function or Use
=====

Historic Functions (Enter categories from instructions)

Cat:	Sub:
Funerary: _____	cemetery _____
_____	_____
Social: _____	clubhouse _____
_____	_____
_____	_____
Religion: _____	_____
_____	_____

Current Functions (Enter categories from instructions)

Cat:	Social: _____	Sub:	meeting hall _____
_____	_____	_____	clubhouse _____
_____	_____	_____	_____

=====
7. Description
=====

Architectural Classification (Enter categories from instructions)

Late Victorian: Gothic Revival _____
Late 19th and 20th Century Revivals: Colonial Revivals _____

Materials (Enter categories from instructions)

foundation	Stone _____
roof	Asphalt shingle _____
walls	Stone _____
	Brick _____
other	12 Stained Glass Windows _____

Narrative Description **See Continuation Sheets, Section 7 for Narrative Description**

=====
8. Statement of Significance
=====

Applicable National Register Criteria (Mark "x" in one or more boxes for the criteria qualifying the property for National Register listing)

- A Property is associated with events that have made a significant contribution to the broad patterns of our history.
- B Property is associated with the lives of persons significant in our past.
- C Property embodies the distinctive characteristics of a type, period, or method of construction or represents the work of a master, or possesses high artistic values, or represents a significant and distinguishable entity whose components lack individual distinction.
- D Property has yielded, or is likely to yield information important in prehistory or history.

Criteria Considerations (Mark "X" in all the boxes that apply.)

- a owned by a religious institution or used for religious purposes.
- b removed from its original location.
- c a birthplace or a grave.
- d a cemetery.
- e a reconstructed building, object, or structure.
- f a commemorative property.
- g less than 50 years of age or achieved significance within the past 50 years.

Areas of Significance (Enter categories from instructions)

Architecture
Art

Period of Significance 1898 Significant Dates 1898

Significant Person

(Complete if Criterion B is marked above) N/A

Cultural Affiliation N/A

Architect/Builder

Architect—Herrick, C. Leroy
Builder—Deeds, Reed

The Oakwood Cemetery Chapel
Summit County, Ohio

Narrative Statement of Significance (Explain the significance of the property on one or more continuation sheets.)

See Continuation Sheets, Section 8, for Narrative Statement of Significance

=====
9. Major Bibliographical References
=====

See Continuation Sheets, Section 9, for Bibliography

Previous documentation on file (NPS)

- preliminary determination of individual listing (36 CFR 67) has been requested.
- previously listed in the National Register
- previously determined eligible by the National Register
- designated a National Historic Landmark
- recorded by Historic American Buildings Survey # _____
- recorded by Historic American Engineering Record # _____

Primary Location of Additional Data

- State Historic Preservation Office
- Other State agency
- Federal agency
- Local government
- University
- Other

Name of repository: Taylor Memorial Public Library, Cuyahoga Falls, Summit County, Ohio

=====
10. Geographical Data
=====

Acreage of Property less than one acre

UTM References (Place additional UTM references on a continuation sheet)

	Zone	Easting	Northing	Zone	Easting	Northing
1	<u>17</u>	<u>459100</u>	<u>4554590</u>	3	_____	_____
2	___	_____	_____	4	_____	_____

See continuation sheet.

Verbal Boundary Description (Describe the boundaries of the property on a continuation sheet.)

The Oakwood Cemetery Chapel
Summit County, Ohio

Boundary Justification
See Continuation Sheet, Section 10, p. 1.

=====
11. Form Prepared By
=====

name/title Kelly R. Falcone
organization N/A date 31 October 1998
street&number 8250 Beaver Ridge Drive, Apt. 1509 telephone (440) 237-6508
city or town North Royalton state OH zip code 44133

=====
Additional Documentation
=====

Submit the following items with the completed form:

Continuation Sheets

Maps

A **USGS map** (7.5 or 15 minute series) indicating the property's location.
A **sketch map** for historic districts and properties having large acreage
or numerous resources.

City of Cuyahoga Falls, **Map of Oakwood Cemetery**
See Continuation Sheet, Additional Documentation, p. 1

Photographs

Representative black and white photographs of the property.
See Continuation Sheet, Additional Documentation, p. 2 for photograph descriptions

Additional items (Check with the SHPO or FPO for any additional items)

1. The original drawings of Oakwood Cemetery Chapel, ca. 1898. Presumably produced by Reed Deeds, chapel builder.
2. Photocopy of the *Cuyahoga Falls Home-Coming Souvenir Volume...Cuyahoga Falls Home-Coming August 19-20, 1908*. Volume includes a photo of the Oakwood Cemetery Chapel ten years after its construction.

=====
Property Owner
=====

name The Ladies Cemetery Association
Susan Drbal, President
street & number 2879 Silver Lake Boulevard telephone (330) 928-8362
city or town Cuyahoga Falls state OH zip code 44221

The Oakwood Cemetery Chapel
Summit County, Ohio

NPS Form 10-900-a
(8-86)

OMB No. 1024-0018

United States Department of the Interior
National Park Service

NATIONAL REGISTER OF HISTORIC PLACES
CONTINUATION SHEET

Section 7 Page 1

The Oakwood Cemetery Chapel
name of property
Cuyahoga Falls, Summit County, Ohio
county and State

=====

DESCRIPTION

Oakwood Cemetery is located along Oakwood Drive and 4th Street in Cuyahoga Falls, Summit County, Ohio, approximately one half mile southeast from downtown Cuyahoga Falls. The Oakwood Cemetery Chapel, built in 1898, is located on its original site near the main (north) entrance of the approximately 25 acre cemetery (See Map of Oakwood Cemetery). Visible from Oakwood Drive, the chapel is situated on a small piece of land near the north entrance to the cemetery, approximately 115 feet from the public road, and is encircled by an asphalt driveway that connects to paved drives into and out of the cemetery (Photos 1a, 1b). Situated in a garden setting, the chapel is surrounded by trees and shrubbery; large evergreens are located within 2 ½ feet of the front porch, trees 4' in diameter within 10' of the northwest corner of the building, and 15-20 rhododendrons on the east side of the building (Photos 1, 3, 5, 9).

A stone on the northwest corner of the chapel building identifies C. L. [Leroy] Herrick [Cuyahoga Falls] as the architect, and Reed Deeds, a late 19th century Cuyahoga Falls contractor for brick work as the builder (Photo 6, 6a). The chapel is a single story, High Victorian Gothic building with a Colonial Revival porch built on a rectangular plan, measuring 40' (north/south) by 20' (east/west). The chapel contains many elements common to the High Victorian Gothic style, including predominant masonry construction, polychrome wall materials and finishes, a complex gable roof, and lancet windows set in pairs and triplets.

On 25 May 1998, a commemorative stone was placed in the garden to honor the chapel's 100th anniversary (Photo 10). A monument (Photo 11) on the east side of the building memorializes The First Board of Directors of The Ladies Cemetery Association founded 4 May 1888, the private organization who erected the chapel in 1898 and retains ownership of the building and the land it sits on. The City of Cuyahoga Falls owns Oakwood Cemetery.

The Oakwood Cemetery office (Photo 7), located 80' north of the chapel and not part of this nomination, is stone with a slate roof and brick trim surrounding the door. Built in 1880, this building was originally used as a receiving vault to store bodies during the harsh winter periods. In 1944, the vault was remodeled to serve as the office of the Cemetery Superintendent. The Oakwood Cemetery office and hundreds of grave markers are visible from the chapel (Photos 7, 7a, 12).

Exterior

The exterior foundation materials at grade to floor level are battered rock face plain ashlar stone. From the floor level to the window sills is four feet around the entire chapel of cut faced random ashlar stone. From the window sills to the eaves is a standard red, smooth faced brick in a common bond with coarse faced soldier bricks used as decorative trim around the windows (Photo 8).

The Oakwood Cemetery Chapel
Summit County, Ohio

NPS Form 10-900-a
(8-86)

OMB No. 1024-0018

United States Department of the Interior
National Park Service

NATIONAL REGISTER OF HISTORIC PLACES
CONTINUATION SHEET

Section number 7 Page 2

Oakwood Cemetery Chapel
Name of property
Cuyahoga Falls, Summit County, Ohio
County and State

The chapel's twelve stained glass memorial windows were donated in 1898 by several early Cuyahoga Falls families and social organizations. There are a total of five stained glass windows on both the east and west facades; the north and south facades have one round oculus stained glass window each (Photos 1, 4). The east and west facades have a bay that projects approximately two feet from the outer wall and reflects an interior alcove. The primary stained glass windows on the east and west elevations decorate the projecting bays of both facades (Photos 5, 9). The windows are triple venetian lancet arched tall center windows flanked by tall, vertical square head windows set in a round top masonry arch recess in the east and west gables. The two remaining windows are tall, approx. 9' 4," Gothic arched lancet windows with coarse brick moorish window heads flanking each bay. Shaped brick lintels frame each window. The last two of the twelve stained glass windows are round, oculus windows. One of the two round stained glass windows is directly above the north entry set inside the north gable end. The second round stained glass window is set in the projecting bay on the south side of the building above the entrance to the basement. In 1976, protective coverings for the twelve stained glass windows were installed. In May 1998, the coverings were replaced to provide a better view of the windows from the exterior.

The open porch on the north facade is an original feature of the Oakwood Cemetery Chapel (See the original building plan). The open porch has a stone foundation and is elevated to floor level; the porch shelters the main entry and supports a wrought iron gate that protects the double front entry doors (Photo 3b). The hip roof of the porch is supported by four white square wooden columns. The white wooden portico that extends approximately two feet from the front of the porch is carried by two of the six square white wooden columns. Five steps are located on the east and west sides of the porch (Photo 3). The front of the porch is closed--a stone in the center of the brickwork reads, "Erected by Ladie's Cem. Asso. 1898" (Photo 2).

The primary structure is approximately 40' north-south by 20' east-west. On the south side is an alcove approximately 3'x10'. Below the main chapel public level is a full basement that was used as the office of the Cemetery Superintendent until 1944. Since then, the chapel basement has been used mainly for maintenance storage. The basement entry is at the south end of the building (Photo 4). The east and west sides of the chapel have alcoves approximately 2'x12'. Each alcove is centered in its respective wall. The gable roof plan is a Greek cross with the primary gable in the north south direction with secondary valley gables on the east and west sides over the alcove projections. The roof soffits are wood, painted white in the plane of the roof slope with decorative rafter ends exposed (Photos 5, 9).

The Oakwood Cemetery Chapel
Summit County, Ohio

NPS Form 10-900-a
(8-86)

OMB No. 1024-0018

United States Department of the Interior
National Park Service

NATIONAL REGISTER OF HISTORIC PLACES
CONTINUATION SHEET

Section number 7 Page 3

Oakwood Cemetery Chapel
Name of property
Cuyahoga Falls, Summit County, Ohio
County and State

During the summer of 1973, the slate roof was removed and replaced with asphalt shingles. This work was done by Mr. Schulpe at a cost of \$1400.00.

Some of the brick on the front porch area was replaced sometime during the 1970's. The exact date is not known as no mention of this repair appears in the Minutes of the Ladies Cemetery Association. According to Mr. Richard Clifford, the cemetery Superintendent from 1968 – 1995, the work was completed sometime in the 1970's. Mr. Clifford does not recall the year.

Interior

The one room interior of the chapel has a carpeted floor. The carpet is not original to the chapel and the date of installation is not known. From the floor to the windowsills is a beaded tongue in groove oak wood paneling (wainscoting) over brick. From the sills to the ceiling is plaster over brick (Photo 20). The ceiling is also plaster and is painted white to match the walls. There are two wooden hammer trusses with horizontal metal rods and Eastlake style brackets, one near the main north entry doors and the other near the south side (Photos 22, 23).

In the late 1970s, the Ladies Cemetery Association funded a \$2,000 renovation project for the chapel interior. At that time, the cemetery superintendent and work crews stripped green paint from the wainscoting. The chapel woodwork today is natural oak finish.

On April 7, 1931 the Ladies Cemetery Association voted to place restrooms in the basement and main floor of the chapel. The plumbing was done by Mr. Frank Patterson and the carpentry work by Mr. S. A. Gilbert.

The Oakwood Cemetery Chapel
Summit County, Ohio

NPS Form 10-900-a
(8-86)

OMB No. 1024-0018

United States Department of the Interior
National Park Service

NATIONAL REGISTER OF HISTORIC PLACES
CONTINUATION SHEET

Section 8 Page 1

The Oakwood Cemetery Chapel

name of property

Cuyahoga Falls, Summit County, Ohio

county and State

=====

NARRATIVE STATEMENT OF SIGNIFICANCE

The Oakwood Cemetery Chapel in Cuyahoga Falls, Summit County, Ohio, is being nominated to the National Register of Historic Places under Criterion C as a fine example of cemetery related architecture. Built in 1898, the chapel is architecturally significant for its eclectic, late 19th century architectural design, strongly inspired by elements common to the High Victorian Gothic style popular ca. 1870-1885. Elements of this style present in the nominated property include predominant masonry construction, polychrome wall materials and finishes, incised ornament, complex gable roofs, and lancet windows set in pairs and triplets. John Ruskin, a late 19th century English author, critic and strong proponent of the High Victorian Gothic argued for the use of stone, brick, marble, and other building materials to achieve contrasting textures. Despite the eclecticism of the Oakwood Cemetery Chapel, the six lancet arched windows on the east and west facades, stone foundation, and patterned brickwork are characteristic of many elements common to the High Victorian Gothic style of architecture.

The Oakwood Cemetery Chapel has many elements common to other late 19th century cemetery chapels of its type in Summit County. For example, the Memorial Chapel at historic Glendale Cemetery in Akron, Ohio, Summit County (see the National Register nomination for Akron Rural Cemetery Group) built 1875-1876 is a fine example of high Victorian Gothic style architecture. Like the Oakwood Chapel, the Glendale Cemetery Memorial Chapel has rock faced ashlar stones walls, pointed Gothic arch pictorial stained glass windows, a gable roof plan, and a front entry porch. However, the Memorial Chapel at Glendale is a more ornate structure than the chapel at Oakwood. The central spire and Gothic front porch contrast with the simplicity of the chapel at Oakwood (Photo 1). Built over twenty years after the chapel at Glendale, the Oakwood chapel has elements of the Colonial Revival style popular after 1880.

The construction of the chapel was made possible by the Ladies Cemetery Association, one of the oldest organizations in Cuyahoga Falls. Founded on 4 May 1888 to assist the trustees of Oakwood Cemetery with grounds maintenance and beautification, the history of the chapel is intertwined with that of the Ladies Cemetery Association and historic Oakwood Cemetery.

Comprised of approximately twenty-five acres, Oakwood Cemetery dates to the earliest settlement of Cuyahoga Falls and has served the community since ca. 1834. When the first New England migrants settled in what became Cuyahoga Falls, their dead were buried first in the yard of a district school. However, when Oakwood Cemetery was laid out in the mid-1830s, the bodies were reinterred and transferred to the cemetery. Today, over 720 veterans of every major military involvement since the War of 1812 are buried at Oakwood. The cemetery is the also the resting place of the families who founded Cuyahoga Falls. Early settlers like Henry Newberry who promoted the industrial growth of the community are buried at Oakwood.

The Oakwood Cemetery Chapel
Summit County, Ohio

NPS Form 10-900-a
(8-86)

OMB No. 1024-0018

United States Department of the Interior
National Park Service

NATIONAL REGISTER OF HISTORIC PLACES
CONTINUATION SHEET

Section 8 Page 2

The Oakwood Cemetery Chapel
name of property
Cuyahoga Falls, Summit County, Ohio
county and State

As the focal point of this historic cemetery for over one hundred years, the Oakwood Cemetery Chapel has played an important role in the history of Cuyahoga Falls. A history of the Ladies Cemetery Association written for the Cuyahoga Falls Centennial in 1912 indicates that these women worked under the direction of the cemetery trustees and collected a fee of 50 cents per annum from each member to be used toward the improvement of the grounds. To raise funds, the Association sponsored dinners, a bazaar, and an ice cream festival, and managed to beautify the cemetery with trees, shrubbery, and flowers. In 1898, ground for the chapel was broken, and Reed Deeds, a Cuyahoga Falls contractor for brick work, was hired to supervise construction.

In 1898, twelve memorial stained glass windows were donated to the chapel by a number of private Cuyahoga Falls families, as well as social and fraternal organizations. The windows survive as beautifully crafted memorials to early settlers and a number of social organizations organized during the last half of the nineteenth century.

East side stained glass memorial windows

North east single lancet window (Photo 13).

- Grant B. Turner and Ada M. Turner memorial window, donated by daughter Alice Whittlesey of Akron. One of the founders of the Turner-Vaughn-Taylor Manufacturing Co. in 1856, Turner was a early industrialist who contributed to the development of Cuyahoga Falls.

Triplet windows (Photo 14):

- Pavonia Lodge No. 301, K. of P., organized on 22 June 1888, was an active, civic minded fraternal order both locally and nationally. A 1912 history of the Pavonia Lodge No. 301 lists chapel builder Reed Deeds among the 54 charter members.
- The Local Star Lodge, F. and A.M., No. 187. Organized 5 October 1850.
- Howard Lodge No. 62. The International Order of Odd Fellows. Organized in Cuyahoga Falls in 1846.

South east side single lancet window (Photo 15):

- Theodore F. Heath, M. D. (1828-1907) and Emma A. Heath (1834-1924) memorial window
Emma A. Heath was the first president of the Ladies Cemetery Association.

The Oakwood Cemetery Chapel
Summit County, Ohio

NPS Form 10-900-a
(8-86)

OMB No. 1024-0018

United States Department of the Interior
National Park Service

NATIONAL REGISTER OF HISTORIC PLACES
CONTINUATION SHEET

Section 8 Page 3

The Oakwood Cemetery Chapel
name of property
Cuyahoga Falls, Summit County, Ohio
county and State

South round oculus window (Photos 16, 17):

- Henry and Eliza B. Wetmore memorial window.
The Wetmores migrated to the Western Reserve from Connecticut in 1804 and are representative of the larger migration of New Englanders to settle northeast Ohio during the first years of settlement. Henry Wetmore was the son of William Wetmore, a land owner and early pioneer of the area. An 1854 Cuyahoga Falls history indicates that the first manufacturing improvement made at Cuyahoga Falls was by Henry Wetmore and his brother, William Wetmore, Jr. on 1 April 1825 by commencement of a dam on the Cuyahoga River.

West side memorial stained glass windows

South west single lancet window (Photo 18):

- Elm Rebekah Lodge No. 227
Organized on 14 August 1888, The Elm Rebekah Lodge No. 227 was an order of ladies very active in Cuyahoga Falls community affairs. In 1898, the Lodge ordered a stained glass window bearing the name and number of the lodge, the emblems of the order and its colors of pink and green to be placed in the chapel, dedicated to the memory of deceased members.

Triplet windows (Photo 19):

- The two identical square head stained glass memorial windows that flank the tall center lancet window are Charles Tiffit and Jane Chase Tiffit memorial windows.

Tall center lancet window (Photo 19):

- Bigelow Lodge No. 243, F. and A.M.
The window likewise reads: "In Memoriam/Rufus L. Willard/Mary Tiffit Willard/Charles A. Willard."

North west single lancet memorial window (Photo 20):

- Donating family or organization unknown due to vandalism. Plain glass replaces any words the window may have included.

North round oculus window (Photo 21):

- Theodosia Grant (d. 1885) memorial window
Grant was the infant daughter of Henry C. and Sarah Grant, two early settlers of Cuyahoga Falls from Connecticut.

The Oakwood Cemetery Chapel
Summit County, Ohio

NPS Form 10-900-a
(8-86)

OMB No. 1024-0018

United States Department of the Interior
National Park Service

NATIONAL REGISTER OF HISTORIC PLACES
CONTINUATION SHEET

Section 8 Page 4

The Oakwood Cemetery Chapel
name of property
Cuyahoga Falls, Summit County, Ohio
county and State

=====

Historic and Current Functions

Dedicated to "all faiths as a service to the community" on 2 July 1898, the non-denominational Oakwood Cemetery Chapel is located on its original site and has retained all of the architectural elements present at the time of its construction, including the aforementioned twelve stained glass windows donated in 1898 (See original building plan; *Cuyahoga Falls Homecoming Souvenir Volume* photo "Chapel at Oakwood Cemetery," 1908). Through the years, the chapel porch has served as the stage for the annual Decoration Day memorial service and public address. The chapel has been the destination for community parades--the "Memorial Day" program for the Cuyahoga Falls Centennial in 1912 was held at the chapel.

There are no religious activities conducted in the chapel today. The chapel is currently used by the Ladies Cemetery Association for their monthly meetings and is open to the public only during the city's annual Memorial Day exercises. The Veterans Memorial Volume, dedicated in 1950, is on display inside the chapel. Maintained by the Ladies Cemetery Association, the volume is made of hand carved white oak and is filled with archival quality paper. Each year, the Ladies update the volume with the names of Cuyahoga Falls veterans who died that year. The book is available for public viewing on Memorial Day, the only day of the year that the chapel is open to the public.

The Oakwood Cemetery Chapel
Summit County, Ohio

NPS Form 10-900-a
(8-86)

OMB No. 1024-0018

United States Department of the Interior
National Park Service

NATIONAL REGISTER OF HISTORIC PLACES
CONTINUATION SHEET

Section number 9 Page 1

The Oakwood Cemetery Chapel
Name of property
Cuyahoga Falls, Summit County, Ohio
County and State

BIBLIOGRAPHY

Primary Sources

- _____. *The Artistic Almanac and Fund of Facts, year '90* [1890]. Compliments of *The Reporter and Western Reserve Farmer*. Cuyahoga Falls, Ohio, 1890. This almanac contains an advertisement for Williston, Deeds & Co., Contractors for Brick Work. Reed Deeds, builder of the Oakwood Cemetery Chapel, is listed as a partner.
- Bierce, General Lucius V. *Historical Reminiscences of Summit County*. Akron: T. & H. G. Canfield, 1854.
- _____. *Cuyahoga Falls Centennial, August 18 to 24, 1812-1912*. Souvenir booklet. Cuyahoga Falls, Ohio, 1912.
- History of the [Ladies] Cemetery Association. Cuyahoga Falls Centennial Documents, 1912. Collection VII, folder 2. Taylor Memorial Public Library, Cuyahoga Falls, Ohio.
- History of Pavonia Lodge # 301, Knights of Pythias. Cuyahoga Falls Centennial Documents, 1912. Collection VII, folder 2. Taylor Memorial Public Library, Cuyahoga Falls, Ohio.
- History of the Pythian Sisters of Cuyahoga Falls, Ohio. Cuyahoga Falls Centennial Documents, 1912. Collection VII, folder 2. Taylor Memorial Public Library, Cuyahoga Falls, Ohio.
- History of Elm Rebekah Lodge, No. 227. Cuyahoga Falls Centennial Documents, 1912. Collection VII, folder 2. Taylor Memorial Public Library, Cuyahoga Falls, Ohio.
- _____. *Illustrated Summit County Ohio*. Akron, Ohio: The Akron Map & Atlas Company, 1891.
- _____. Original drawings of the Chapel at Oakwood Cemetery, ca. 1898. The City of Cuyahoga Falls. The drawings do not appear to be the work of the architect. Because notes pertain mainly to building materials, the sketches were probably made by the builder, Reed Deeds, or a member of his crew.

The Oakwood Cemetery Chapel
Summit County, Ohio

NPS Form 10-900-a
(8-86)

OMB No. 1024-0018

United States Department of the Interior
National Park Service

NATIONAL REGISTER OF HISTORIC PLACES
CONTINUATION SHEET

Section number 9 Page 2

The Oakwood Cemetery Chapel

Name of property

Cuyahoga Falls, Summit County, Ohio

County and State

Secondary Sources

Blumenson, John. *Identifying American Architecture*. Nashville: American Association for State and Local History, 1977.

Downey, Gerry B. "The Ladies' Cemetery Association." *Cuyahoga Falls 175th Anniversary, 1812-1987*. Cuyahoga Falls, Ohio: 175th Anniversary Commemorative Book Committee, 1987.

Gordon, Stephen C. *How to Complete the Ohio Historic Inventory*. Columbus, Ohio: Ohio Historic Preservation Office, 1992.

_____. "HS [Historical Society] meets at chapel." *The Falls News Press*, 11 May 1981.

Hitchcock, Henry-Russell. *Architecture: Nineteenth and Twentieth Centuries*. Penguin Books, 1983.

McClure, Mary. "History is Monumental at Oakwood." *City Press*, 30 May 1979.

_____. "There's Lots More Than Meets the Eye." 25 May 1981.

_____. National Register Bulletin. How to Complete the National Register Registration Form, revised 1997. U. S. Department of the Interior, National Park Service, National Register of Historic Places.

"Oakwood Cemetery Chapel." Ohio Historic Inventory Number SUM-726-8. Ohio Historic Preservation Office, 1982.

Pothorn, Herbert. *Architectural Styles*. New York: The Viking Press, Inc., 1971.

Thompson, Eric J. Presentation to the Cuyahoga Falls Historical Society, 13 May 1981.

Thompson, Eric J. "Oakwood Cemetery." *Falls News*, May 1980.

Whiffen, Marcus. *American Architecture Since 1780: A Guide to the Styles*. Cambridge: M.I.T. Press, 1969.

The Oakwood Cemetery Chapel
Summit County, Ohio

NPS Form 10-900-a

OMB No. 1024-0018

(8-86)

United States Department of the Interior
National Park Service

NATIONAL REGISTER OF HISTORIC PLACES
CONTINUATION SHEET

Section number 10 Page 1

The Oakwood Cemetery Chapel

Name of property

Cuyahoga Falls, Summit County, Ohio

County and State

VERBAL BOUNDARY DESCRIPTION

The nominated property is bounded on all sides by an asphalt circular drive leading into and out of Oakwood Cemetery. The drive encircling the chapel serves as the boundary of the nominated property. The chapel sits on a piece of land not more than a quarter of an acre in size.

BOUNDARY JUSTIFICATION

The boundaries of the nominated property were selected to include only the chapel and the small piece of land on which it is situated. Ownership of the Oakwood Cemetery Chapel and this piece of land is retained by a private organization. The remainder of Oakwood Cemetery is owned by the municipality.

The Oakwood Cemetery Chapel
Summit County, Ohio

NPS Form 10-900-a
(8-86)

OMB No. 1024-0018

United States Department of the Interior
National Park Service

NATIONAL REGISTER OF HISTORIC PLACES
CONTINUATION SHEET

Section number Additional Documentation
Photographs

Page 1

Oakwood Cemetery Chapel
Name of property
Cuyahoga Falls, Summit County, Ohio
County and State

PHOTOGRAPHS

The following information is the same for all photographs:

Oakwood Cemetery Chapel

Oakwood Cemetery, Cuyahoga Falls, Summit County, Ohio

Photographer: Kelly R. Falcone

Date: November 1998

Exterior:

- 1) north facade
- 1a) north facade "setting view"
- 1b) northwest facade "setting view"
- 2) north facade; stone set in porch brickwork; "Erected by Ladie's Cem. Asso. 1898"
- 3) northeast facade
- 3a) porch; northeast facade
- 3b) double front entry doors
- 4) south facade with basement entry open
- 5) west facade
- 6) cornerstone on northwest corner, reads "C. L. HERRICK/ARCHIT./REED DEEDS/BUILDER"
- 6a) cornerstone on northwest corner, detail
- 7) looking north at cemetery office, grave markers
- 7a) cemetery office
- 8) west facade, south; ornamental brick detail around top half of single lancet arch stained glass window
- 9) east facade with rhododendrons
- 10) "Chapel at Oakwood Cemetery" 100th anniversary commemorative stone. 25 May 1998.
- 11) "Memorial to the First Board of Directors of The Ladies Cemetery Association" commemorative monument.
- 12) looking west from the cemetery chapel

United States Department of the Interior
National Park Service

**NATIONAL REGISTER OF HISTORIC PLACES
CONTINUATION SHEET**

Section number Additional Documentation
Photographs

Page 2

Oakwood Cemetery Chapel

Name of property

Cuyahoga Falls, Summit County, Ohio

County and State

Interior:

- | | | | |
|-----|-------------------|---|---|
| 13) | northeast corner: | single lancet arch/center triplet windows: | Grant B. and Ada M. Turner |
| 14) | facing east: | center triplet windows: | Pavonia Lodge No. 301
Local Star Lodge No. 187
Howard Lodge No. 62
Theodore and Emma Heath |
| 15) | southeast corner: | single lancet arch window: | |
| 16) | facing south: | round oculus stained glass window; oak wainscoting; truss | |
| 17) | facing south: | round oculus window: | Henry and Eliza Wetmore |
| 18) | southwest corner: | single lancet arch window: | Elm Rebekah Lodge No. 227 |
| 19) | facing west: | center triplet: | Charles Tiff
Rufus L. Willard
Jane Chase Tiff
unknown |
| 20) | northwest corner: | single lancet arch window;
wainscoting, plaster wall | |
| 21) | facing north: | main entry; round oculus stained glass window: | Theodosia Grant |
| 22) | truss: | north entry | |
| 23) | truss: | south | |

United States Department of the Interior
National Park Service

NATIONAL REGISTER OF HISTORIC PLACES
CONTINUATION SHEET

Section number Additional Documentation

Page # 3

Oakwood Cemetery Chapel

Name of property

Cuyahoga Falls, Summit County, Ohio

County and State

SKETCH MAP

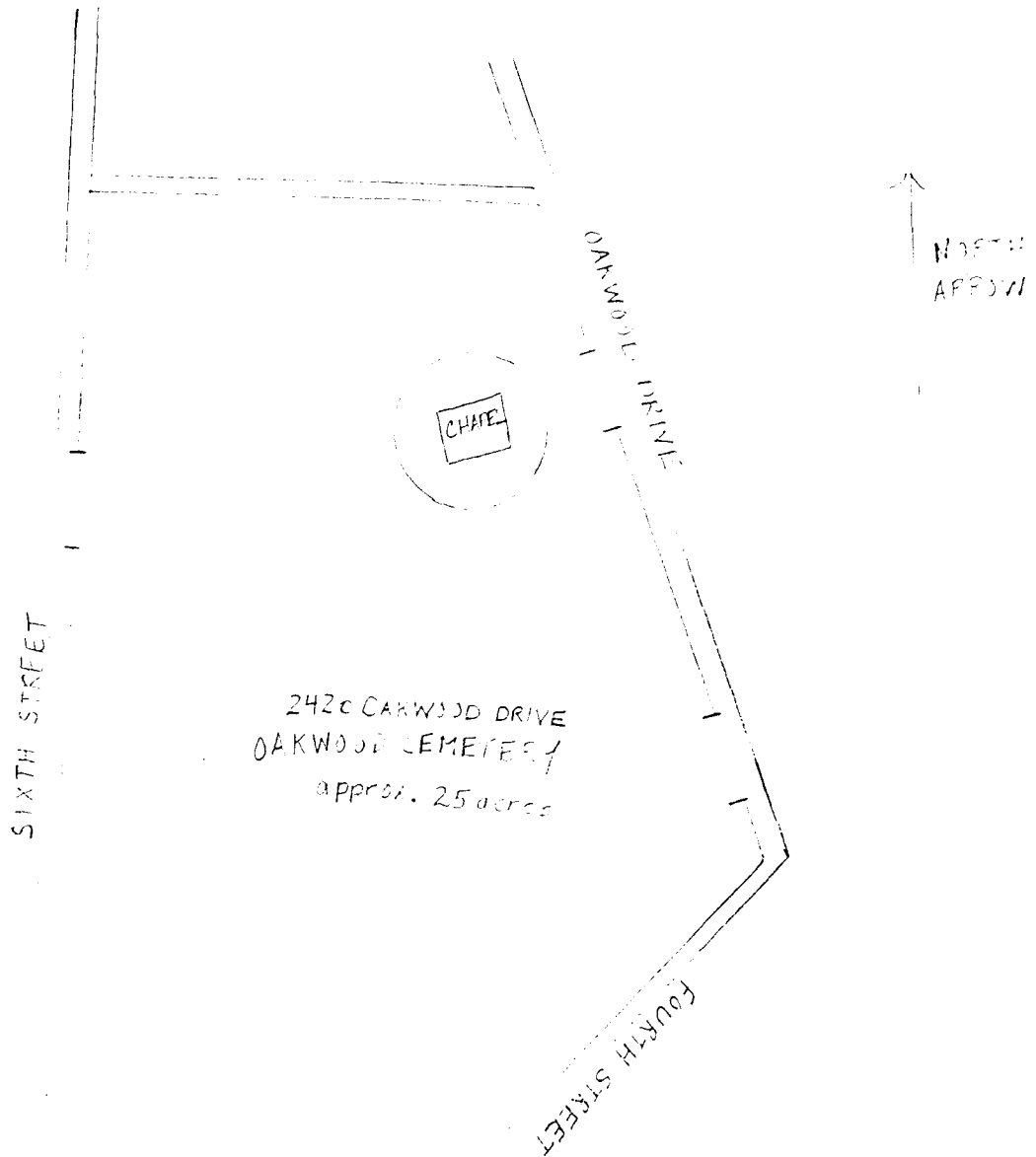

(SKETCH NOT DRAWN TO SCALE)

The Oakwood Cemetery Chapel
Summit County, Ohio

20

NPS Form 10-900-a
(8-86)

OMB No. 1024-0018

United States Department of the Interior
National Park Service

NATIONAL REGISTER OF HISTORIC PLACES
CONTINUATION SHEET

Section number Additional Documentation
Photographs

Page 1

Oakwood Cemetery Chapel

Name of property

Cuyahoga Falls, Summit County, Ohio

County and State

PHOTOGRAPHS - *Color Slides*

The following information is the same for all:

Oakwood Cemetery Chapel

Oakwood Cemetery, Cuyahoga Falls, Summit County, Ohio

Photographer: Jeff Amburn

July/August 1999

Exterior:

- 1) North facade
- 2) Northeast facade setting view
- 3) East facade
- 4) East facade setting view
- 5) Southwest facade setting view
- 6) West facade
- 7) Cemetery office
- 8) Cornerstone on northwest corner

NPS Form 10-900-a

OMB No. 1024-0018

(8-86)

United States Department of the Interior
National Park Service

**NATIONAL REGISTER OF HISTORIC PLACES
CONTINUATION SHEET**

Section number Additional Documentation
Photographs

Page 2

Oakwood Cemetery Chapel

Name of property

Cuyahoga Falls, Summit County, Ohio

County and State

13)	North	over main entry; round oculus stained glass window	Theodosia Grant
14)	North	truss	
15)	Northeast corner	single lancet arch window	Grant B. and Ada Turner
16)	East	center triplet windows	Pavonia Lodge No. 301 Local Star Lodge No. 187
17)	Southeast corner	single lancet arch window	Theodore and Emma Heath
18)	South	round oculus window	Henry and Eliza Wetmore
19)	South	truss	
20)	Southwest corner	single lancet window	Elm Rebekah Lodge No. 227
21)	West	center triplet windows	Charles Tift Rufus L. Willard Jane Chase Tift
22)	Northwest Corner	single lancet window	Unknown

Map of Oakwood Cemetery

Charges for Cemetery Services

◆ Adult Grave-Resident	\$375.00
◆ Adult Grave-Non Resident	600.00
◆ Infant Grave-Resident	100.00
◆ Infant Grave-Non Resident	150.00
◆ Perpetual Care-Adult Resident	75.00
◆ Perpetual Care-Adult Non-Resident	120.00
◆ Perpetual Care-Infant Resident	20.00
◆ Perpetual Care-Infant Non-Resident	30.00
◆ Interment-Adult	415.00
◆ Interment-Infant	150.00
◆ Interment-Saturday/Holidays*	300.00
◆ Interment-Cremains**	200.00
◆ Disinterment-Adult	600.00
◆ Disinterment-Infant	250.00
◆ Reinterment-Adult	600.00
◆ Reinterment-Infant	250.00
◆ Columbarium Niche-Resident	400.00
◆ Columbarium-Non-Resident	600.00
◆ Interment-Cremains(In Niche)	50.00
◆ Cremation Plot-Resident	200.00
◆ Cremation Plot-Non Resident	300.00
◆ Perpetual Care-Cremation-Resident	40.00
◆ Perpetual Care-Cremation-Non-Resident	60.00
◆ Foundations (Poured Concrete)	65.00 Sq Ft
◆ Foundations (Flat Granite)	35.00 Sq Ft
◆ Transfer Fee	50.00
◆ Veterans Marker Setting***	50.00

*Additional Fee

**Accommodates two cremains

***Must be paid at time of application

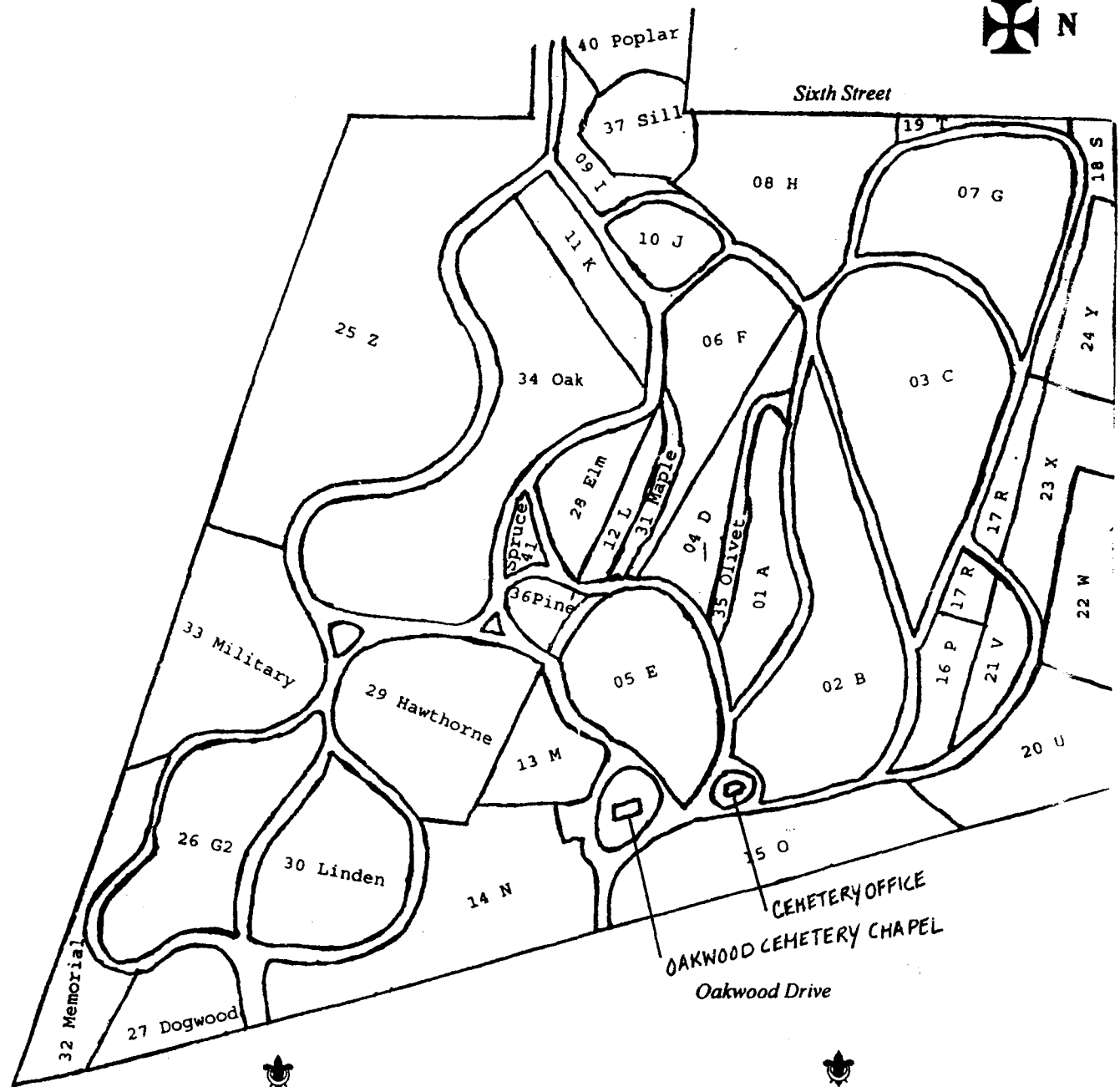

OAKWOOD CEMETERY CHAPEL
OAKWOOD CEMETERY

UTM REF:

17/459100/4554540

(AKRON WEST)
4656 11 SE

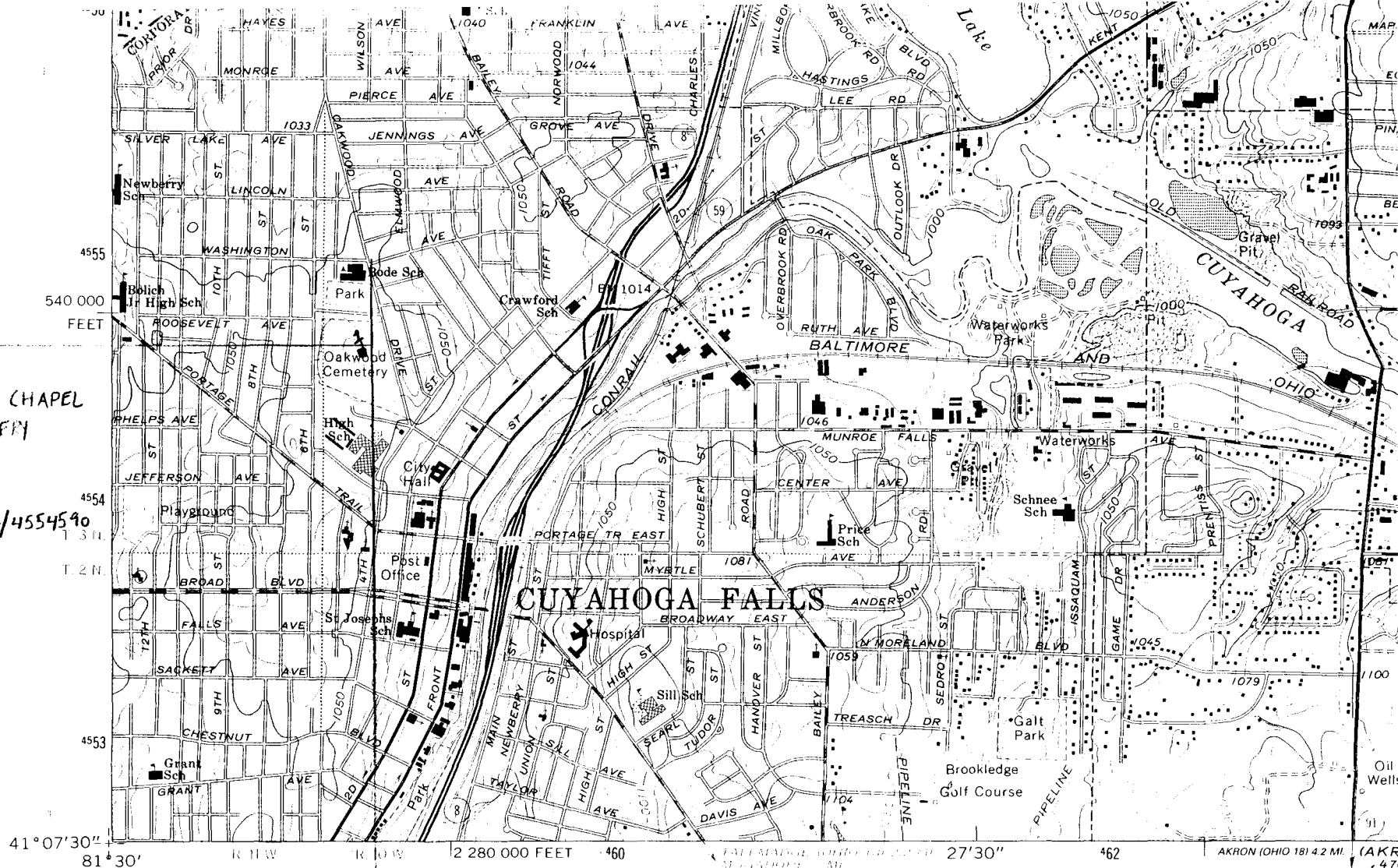

Mapped, edited, and published by the Geological Survey
Revised in cooperation with State of Ohio agencies

Control by USGS and NOS/NOAA

Topography by photogrammetric methods from aerial photographs taken 1952 and planetable surveys 1953. Revised by photogrammetric methods from aerial photographs taken 1962. Field checked 1963

Polyconic projection. 10,000-foot grid ticks based on Ohio coordinate system, north zone
1000-meter Universal Transverse Mercator grid ticks, zone 17, shown in blue
1927 North American Datum
To place on the predicted North American Datum 1983 move the projection lines 2 meters south and 14 meters west as shown by dashed corner ticks

Fine red dashed lines indicate selected fence and field lines where generally visible on aerial photographs. This information is unchecked
Red tint indicates areas in which only landmark buildings are shown
Entire area lies within the Connecticut Western Reserve. Land lines established by private subdivision of the Connecticut Western Reserve
There may be private inholdings within the boundaries of the National or State reservations shown on this map

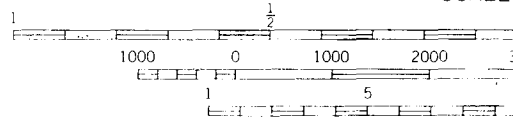
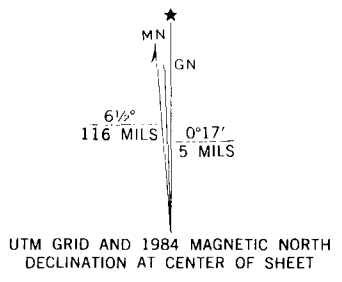

CONTOUR INTERVAL
NATIONAL GEODETIC VE

THIS MAP COMPLIES WITH NATIONAL
FOR SALE BY U. S. GEOLOGICAL SURVEY
OR RESTON, VA
A FOLDER DESCRIBING TOPOGRAPHIC MAPS

Ohio Historic Preservation Office

567 East Hudson Street
Columbus, Ohio 43211-1030
614/ 297-2470 Fax: 614/ 297-2496

Visit us at www.ohiohistory.org/resource/histpres/



**OHIO
HISTORICAL
SOCIETY**
SINCE 1885

November 23, 1999

Susann Drbal
Ladies Cemetery Association
2879 Silver Lake Blvd.
Silver Lake OH 44224

Dear Ms. Drbal:

Congratulations on the recent listing of your property into the National Register of Historic Places!

The National Park Service, United States Department of the Interior listed the **Chapel in Oakwood Cemetery** at 2420 Oakwood Drive in Summit County, Cuyahoga Falls, OH on November 12, 1999. The nomination was made in connection with a state plan to identify and document prehistoric and historic places in Ohio which qualify for National Register status under provisions of the National Historic Preservation Act of 1966 as amended.

The Ohio Historic Preservation Office (OHPO) is available to advise you in maintaining the historic character of your property. As you know from previous mailings received from this office, there are no restrictions placed on your property following the National Register listing. However, the OHPO strongly encourages owners of historic properties to consider all options before completing work that could damage the structure or impair its historic integrity. Careful planning can facilitate the sensitive incorporation of contemporary alterations with the historic fabric. The OHPO provides free information on how to sensitively rehabilitate and repair historic properties, upon request.

Thank you for your interest in historic preservation and the National Register of Historic Places.

Sincerely,

Barbara A. Powers
Department Head
Planning, Inventory and Registration.

Cc: Kelly Falcone, Form Preparer
Jeff Amburn, City of Cuyahoga Falls
Don Robart, Mayor
Senator Roy Ray, District 27
Representative Kevin Coughlin, District 46
Akron Metropolitan Area Transportation Study
Ohio Department of Transportation

Ohio Historic Preservation Office

National Register of Historic Places File Checklist

The following materials are contained in this file of the National Register form for:

Name: Oakwood Cemetery Chapel

County: Summit

Original National Register of Historic Places nomination form

Multiple Property Nomination form

Photograph(s)

Photograph(s) (copies)

USGS map(s)

USGS map(s) (copies)

Sketch map(s)/figure(s)/exhibit(s)

Correspondence

Other postcard
