

Ref# 75001539

Form 10-300  
(Rev. 6-72)

UNITED STATES DEPARTMENT OF THE INTERIOR  
NATIONAL PARK SERVICE

### NATIONAL REGISTER OF HISTORIC PLACES INVENTORY - NOMINATION FORM

(Type all entries - complete applicable sections)

STATE:	OHIO
COUNTY:	SUMMIT
FOR NPS USE ONLY	
ENTRY DATE	7/30/75

#### 1. NAME

COMMON: Western Reserve Academy

AND/OR HISTORIC: Western Reserve College - Academy

#### 2. LOCATION

STREET AND NUMBER:  
(See Continuation Sheet)

CITY OR TOWN: Hudson

CONGRESSIONAL DISTRICT: 11 -J. William Stanton

STATE: Ohio

CODE: 039

COUNTY: Summit

CODE: 153

#### 3. CLASSIFICATION

CATEGORY (Check One)	OWNERSHIP	STATUS	ACCESSIBLE TO THE PUBLIC
<input checked="" type="checkbox"/> District <input type="checkbox"/> Site <input type="checkbox"/> Object <input type="checkbox"/> Building <input type="checkbox"/> Structure <input type="checkbox"/> Object	<input type="checkbox"/> Public <input checked="" type="checkbox"/> Private <input type="checkbox"/> Both	Public Acquisition: <input type="checkbox"/> In Process <input type="checkbox"/> Being Considered	<input checked="" type="checkbox"/> Occupied <input type="checkbox"/> Unoccupied <input type="checkbox"/> Preservation work in progress Yes: <input checked="" type="checkbox"/> Restricted <input type="checkbox"/> Unrestricted <input type="checkbox"/> No
PRESENT USE (Check One or More as Appropriate)			
<input type="checkbox"/> Agricultural <input type="checkbox"/> Commercial <input checked="" type="checkbox"/> Educational <input type="checkbox"/> Entertainment	<input type="checkbox"/> Government <input type="checkbox"/> Industrial <input type="checkbox"/> Military <input checked="" type="checkbox"/> Museum	<input type="checkbox"/> Park <input checked="" type="checkbox"/> Private Residence <input checked="" type="checkbox"/> Religious <input checked="" type="checkbox"/> Scientific	<input type="checkbox"/> Transportation <input type="checkbox"/> Other (Specify) _____ <input type="checkbox"/> Comments _____

#### 4. OWNER OF PROPERTY

OWNER'S NAME: Western Reserve Academy, Bradford Burnham, W.E. Crisp, John Stethem

STREET AND NUMBER:

CITY OR TOWN: Hudson

STATE: Ohio

CODE: 44236

CODE: 039

#### 5. LOCATION OF LEGAL DESCRIPTION

COURTHOUSE, REGISTRY OF DEEDS, ETC.: Summit County Courthouse - Summit County Records Office

STREET AND NUMBER: 209 S. High Street

CITY OR TOWN: Akron

STATE: Ohio

CODE: 039

#### 6. REPRESENTATION IN EXISTING SURVEYS

TITLE OF SURVEY: 1950 Record of Old Homes, Hudson, Ohio,

DATE OF SURVEY: 1950

DEPOSITORY FOR SURVEY RECORDS: Hudson Library & Historical Society

STREET AND NUMBER: 22 Aurora Street

CITY OR TOWN: Hudson

STATE: Ohio

CODE: 039

SEE INSTRUCTIONS

STATE:	Ohio
COUNTY:	Summit
ENTRY NUMBER	
DATE	

FOR NPS USE ONLY

7. DESCRIPTION

CONDITION	(Check One)					
	<input checked="" type="checkbox"/> Excellent	<input type="checkbox"/> Good	<input type="checkbox"/> Fair	<input type="checkbox"/> Deteriorated	<input type="checkbox"/> Ruins	<input type="checkbox"/> Unexposed
	(Check One)			(Check One)		
	<input checked="" type="checkbox"/> Altered	<input type="checkbox"/> Unaltered	<input type="checkbox"/> Moved	<input checked="" type="checkbox"/> Original Site		

DESCRIBE THE PRESENT AND ORIGINAL (if known) PHYSICAL APPEARANCE

The original campus of Western Reserve College/Academy was planned in the early 1820's, and the first cornerstone of the first building was laid in 1826. This building was afterward called Middle College. Its chief characteristic was an open cylindrical belfry with wooden pillars supporting a dome surmounted by a flagstaff. This building eventually outlived its usefulness and was razed in 1912. South College was built in 1829-30 of stone and brick, had four stories, no belfry, and a chapel was on the ground floor. It was also razed in 1884, but all other permanent college buildings remain.

The President's House (1829-30) was a two-storied brick building built to house the President on one side and the Professor of Theology on the other. While the north half was actually occupied by the president from 1830-71, the south half was rarely tenanted by a professor of Theology. This early Federal house has fanlighted doorways that are simple and graceful. It has been renovated at various times, and in 1959, the original exterior appearance was restored. Some mantelpieces removed at that time are preserved elsewhere. This building was built by Simeon and Orrin Porter.

The Chapel (1835-36) is a Greek Revival building mixed with early Federal, built by Simeon and Orrin Porter, sons of Lemuel Porter who had contracted to build the college buildings, but had died in 1829. As Mr. Campen says in Architecture of the Western Reserve 1800-1900, "this without doubt is the most important work of architecture in a town rich in good architecture." The Grecian Doric pilasters on front beneath white Doric entablature become piers in shallow relief on the side walls, while moldings of capitals are replaced by Georgian elliptical arches. It could be a reluctance to pay for the additional entablature on four sides, or to give an arcade motif which would be used again on the Athenaeum. The tower uses pilasters with Greek frets set in sunken panels, a motif from Asher Benjamin's Practical House Carpenter. The pediment window with globe-of-the-world tracery remains early Federal. The interior is severely plain; with the gallery columns cithrespin-like with exaggerated entasis, are Grecian Doric. The one similarity to Yale is that the first floor was planned as the Library. The stairway was originally single from double west doors; but it was changed in 1871-72 to two side stairways. In 1936 the building was completely renovated, and in 1940 a 22-foot extension to the rear was added housing a pipe organ. The tower of the chapel was originally three-tiered with square members of equal height, but diminishing diameter. The lowest housed the bell, next for the clock (installed before October 1837) and the top for the flagstaff. The latter blew off in a windstorm around the turn of the century and was never replaced.

North College (1837-38) is highly simplified Greek Revival with a hip roof. It is plain four-storied brick with Greek frets in central openings and doorways, pilaster-like jambs, and entablature-like heads which appear to have been originally cambered lintels. The building was not meant to stand alone architecturally, but to be one of the "brick row" of campus buildings.

The Observatory (1838) was built by Simeon Porter to the specifications of Professor Elias Lewis, the Math & Astronomy professor of WAC. It is a simple symmetrical building of three members: the central one carrying a revolving dome. The building housed a transit circle and equatorial telescope both built by Troughton & Simms of London in 1837. The astronomical clock

SEE INSTRUCTIONS

**6. SIGNIFICANCE**

PERIOD (Check One or More as Appropriate)

- |  |                                       |  |  |
|--|---------------------------------------|--|--|
| <input type="checkbox"/> Pre-Columbian | <input type="checkbox"/> 16th Century | <input type="checkbox"/> 18th Century            | <input checked="" type="checkbox"/> 20th Century |
| <input type="checkbox"/> 15th Century  | <input type="checkbox"/> 17th Century | <input checked="" type="checkbox"/> 19th Century |  |

SPECIFIC DATE(S) (If Applicable and Known)

AREAS OF SIGNIFICANCE (Check One or More as Appropriate)

- |  |   |  |   |
|--|---|--|---|
| <input type="checkbox"/> Aboriginal              | <input checked="" type="checkbox"/> Education   | <input type="checkbox"/> Political           | <input type="checkbox"/> Urban Planning             |
| <input type="checkbox"/> Prehistoric             | <input type="checkbox"/> Engineering            | <input type="checkbox"/> Religion/Philosophy | <input type="checkbox"/> Other (Specify)            |
| <input type="checkbox"/> Historic                | <input type="checkbox"/> Industry               | <input type="checkbox"/> Science             | <input checked="" type="checkbox"/> campus planning |
| <input type="checkbox"/> Agriculture             | <input type="checkbox"/> Invention              | <input type="checkbox"/> Sculpture           | _____   |
| <input checked="" type="checkbox"/> Architecture | <input type="checkbox"/> Landscape Architecture | <input type="checkbox"/> Social/Humanitarian | _____   |
| <input type="checkbox"/> Art                     | <input type="checkbox"/> Literature             | <input type="checkbox"/> Theater             | _____   |
| <input type="checkbox"/> Commerce                | <input type="checkbox"/> Military               | <input type="checkbox"/> Transportation      | _____   |
| <input type="checkbox"/> Communications          | <input type="checkbox"/> Music                  |  | _____   |
| <input type="checkbox"/> Conservation            |   |  | _____   |

STATEMENT OF SIGNIFICANCE

Western Reserve Academy is on the ground originally established as Western Reserve College. The college was an outgrowth of interest of Hudson people in general and the Erie Literary Society in particular. From 1822, plans were worked on, and in 1826, the college was founded. The village founders were also active in the founding of the college and its growth. The land they sold and donated to the college provided actual facilities and income to carry on. The Academy was founded as a prep school in conjunction with the college. As years went by, more land was acquired through bequests and purchases. Some people involved are indicated by the street names surrounding the campus area. Baldwin Street reflects the college treasurer Augustus Baldwin, Hudson Street after David Hudson, and Oviatt Street after Heman Oviatt who gave 114 acres to the college in lieu of a note to endow a professorship in 1838. College Street runs through the middle of the campus. WRC influenced village life; men came to teach and stayed to enrich the community. Abolition was argued on campus and in town and caused both a church and college split. The Oberlin branch of the Congregational Church and Oberlin College itself were founded in this spirit. However, the pro-abolitionists later found more sympathy in both village and college circles. Although founded with a Theological School in mind, it grew in academic breadth, and after 1853, theology was no longer taught.

The campus was designed to be a "brick row" facing west on an elevation overlooking the village green. The original buildings from the President's House on the north to the Observatory on the south formed the nucleus of professors' homes and those of others connected with college life. Professor Seymour (Prof. of Greek & Latin) built the only house in what was supposed to become another "brick row" of professors' houses. President Pierce built a home just north of the campus, and various other professors built homes around the area. Some of these houses have been purchased by the Academy over the years, while others that had belonged to college people are now simply private dwellings.

In 1882 the college moved itself and its facilities to Cleveland. The academy remained in Hudson. The academy had had separate financing since 1850, and was modestly subsidized by WRC from the move in 1882 until 1900 when this subsidy ceased. In 1900 James Ellsworth, a philanthropist of local origins, pledged \$50,000 to support WRA. However, the pledge needed to be met with a like amount from the village and this was not forthcoming, thus the academy closed its doors from 1903 until 1916.

Mr. Ellsworth persevered, and in 1910 the Hudson campus ownership was

SEE INSTRUCTIONS

**9. MAJOR BIBLIOGRAPHICAL REFERENCES**

"1950 Record of Old Houses of Hudson Ohio"  
 "Hudson, Early 19th Century Domestic Architecture," Patricia Smith Ingram,  
 "Early Homes of Ohio," I.T. Frary, 1936 / May, 1953  
 "Architecture of the Western Reserve 1800-1900," Richard N. Campen, 1971  
 "Western Reserve Vuniversity, The Hudson Era, " 1826-82, Frederick C. Waite,  
 Cleveland, 1943  
 "James Ellsworth & Refounding of Western Reserve Academy" J.F. Waring, Hudson  
 Ohio, 1961  
 "The Growing Years 1926-46," Western Reserve Academy, J.F. Waring, Hudson,  
 Ohio, 1972

**10. GEOGRAPHICAL DATA**

LATITUDE AND LONGITUDE COORDINATES DEFINING A RECTANGLE LOCATING THE PROPERTY			O R	LATITUDE AND LONGITUDE COORDINATES DEFINING THE CENTER POINT OF A PROPERTY OF LESS THAN TEN ACRES		
CORNER	LATITUDE	LONGITUDE		LATITUDE	LONGITUDE	
	Degrees Minutes Seconds	Degrees Minutes Seconds		Degrees Minutes Seconds	Degrees Minutes Seconds	
NW	41 ° 14 ' 58.	81 ° 26 ' 28.				
NE	41 ° 14 ' 58.	81 ° 26 ' 01.				
SE	41 ° 14 ' 35.	81 ° 26 ' 01.				
SW	41 ° 14 ' 35.	81 ° 26 ' 28.				

APPROXIMATE ACREAGE OF NOMINATED PROPERTY: 58 acres

LIST ALL STATES AND COUNTIES FOR PROPERTIES OVERLAPPING STATE OR COUNTY BOUNDARIES

STATE:	CODE	COUNTY	CODE
Ohio		Summit	
STATE:	CODE	COUNTY:	CODE
STATE:	CODE	COUNTY:	CODE
STATE:	CODE	COUNTY:	CODE

**11. FORM PREPARED BY**

NAME AND TITLE:  
Thirza M. Cady, Asst. to Janet Sprague, Archivist

ORGANIZATION: Hudson Library & Historical Society      DATE: 30 Dec 1973

STREET AND NUMBER:  
22 Aurora Street

CITY OR TOWN: Hudson      STATE: Ohio      CODE:

**12. STATE LIAISON OFFICER CERTIFICATION**

**NATIONAL REGISTER VERIFICATION**

As the designated State Liaison Officer for the National Historic Preservation Act of 1966 (Public Law 89-665), I hereby nominate this property for inclusion in the National Register and certify that it has been evaluated according to the criteria and procedures set forth by the National Park Service. The recommended level of significance of this nomination is:

National  State  Local

Name \_\_\_\_\_

Title \_\_\_\_\_

Date \_\_\_\_\_

I hereby certify that this property is included in the National Register.

\_\_\_\_\_  
 Director, Office of Archeology and Historic Preservation

Date \_\_\_\_\_

ATTEST:

\_\_\_\_\_  
 Keeper of The National Register

Date \_\_\_\_\_

SEE INSTRUCTIONS

NATIONAL REGISTER OF HISTORIC PLACES  
INVENTORY - NOMINATION FORM

(Continuation Sheet)

STATE		OHIO
COUNTY		SUMMIT
FOR NPS USE ONLY		
ENTRY NUMBER	DATE	

(Number all entries)

2. Location of Western Reserve Academy Historical District

Beginning at the intersection of Oviatt and Aurora Streets to the intersection of Aurora and College Streets; then north on College Street to the north side of Chapel Street; west to North Main Street; north on Main Street to the David Hudson House property, around the 2.5 A.'s of the property, back to Main; north to the northeast corner of Prospect and Main Streets; east across the rear property lines on the north side of Prospect to College Street. Then north on the west side of College Street around the property lines of the Cartwright House, crossing the intersection of College and High Streets to the east side of College Street; north to include the Headmaster's house (#1), then south on a line some 400 ft. east of College Street to a line 200 ft. north of Hudson Street; east on this line on the north side of Hudson Street to Oviatt Street; southeast to include the property of the Hosford House, and south on the east side of Oviatt Street to the point of beginning.

Map Legend:

- |                           |                          |
|---------------------------|--------------------------|
| 1. President Pierce House | 10. North Hall           |
| 2. Cartwright House       | 11. The Chapel           |
| 3. Athenaeum              | 12. Seymour Hall         |
| 4. Cutler House           | 13. Wilson Hall          |
| 5. Morley Cottage         | 14. Crisp House          |
| 6. Nutting House          | 15. The Observatory      |
| 7. Potwin Cottage         | 16. (David) Hudson House |
| 8. Hosford House          | 17. Seymour House        |
| 9. President's House      | 18. Gymnasium            |

Additional (new) Buildings:

- A. Ellsworth Hall
- B. Hobart House
- C. Harlan N. Wood House

NATIONAL REGISTER OF HISTORIC PLACES  
INVENTORY - NOMINATION FORM

(Continuation Sheet)

STATE Ohio	
COUNTY	
Summit FOR NPS USE ONLY	
ENTRY NUMBER	DATE

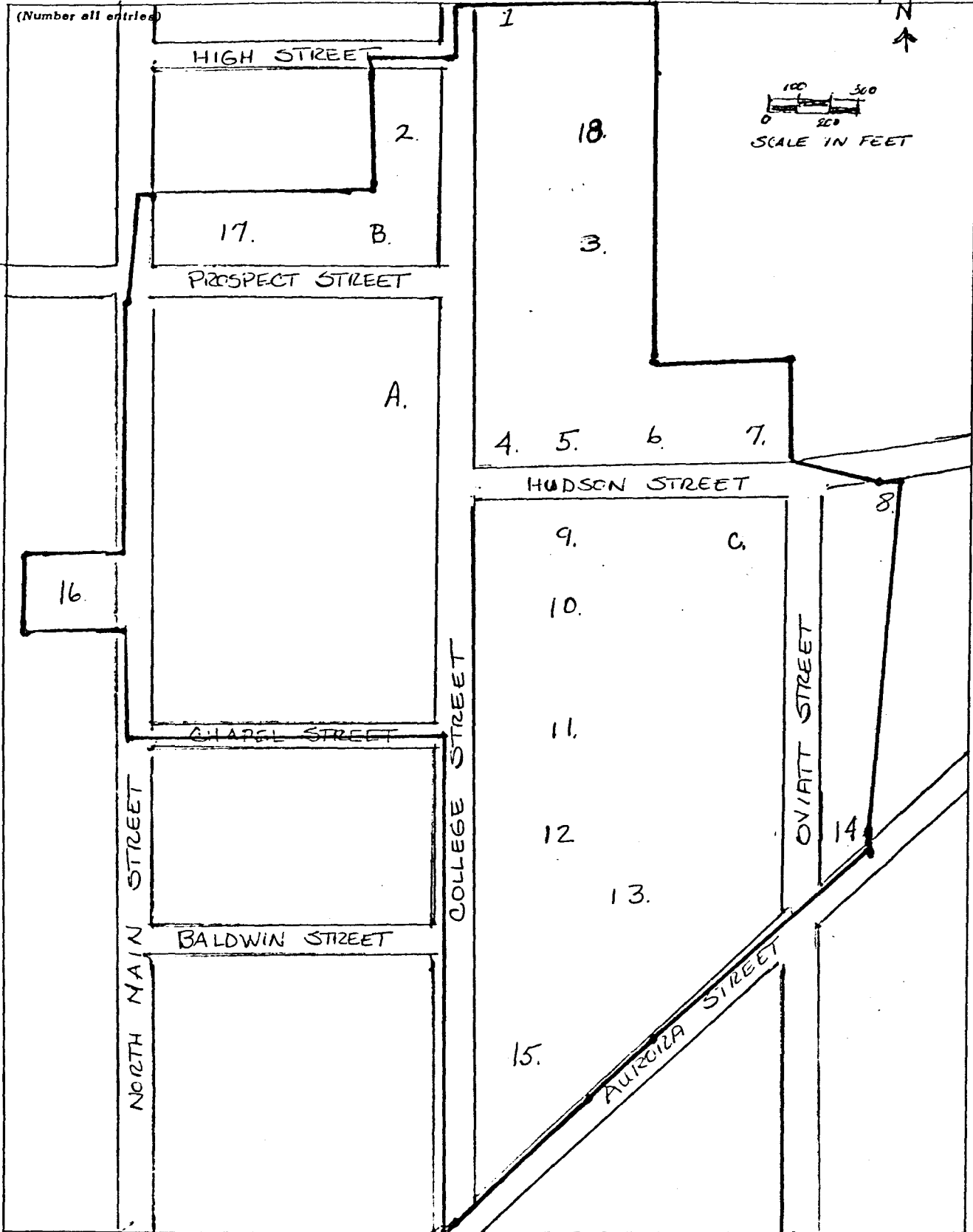

NATIONAL REGISTER OF HISTORIC PLACES  
INVENTORY - NOMINATION FORM

(Continuation Sheet)

STATE	OHIO	
COUNTY	SUMMIT	
FOR NPS USE ONLY		
ENTRY NUMBER		DATE

(Number all entries) Page 2 - Physical Appearance  
 was built by Robert Molyneux of London. The instruments were moved to Cleveland with the College, but the telescopes were returned when the Academy was reactivated (1916.) The clock was returned in 1963. The dome was originally tin-plated, but this was replaced by copper in 1924.

The last of the campus buildings in this early period of the College was the Athenaeum (1841-43.) This Classic Revival designed and built by Simeon Porter resembles the Chapel with blind arcades used to decorate the facade. The main entrance was originally on the west end of the building. The rooms were used for recitation, with student organizations and fraternities also meeting there till 1870. Also, the lab was on the ground floor, and the museum on the top floor. In 1890, the tower was removed, and in 1916, the building was changed from three to four stories, and the entrance changed to the south side.

After the reactivation of the Academy under the influence and financing of James Ellsworth, various additional buildings were erected. Seymour Hall (1914) was built by Page and Corbusier on the ground where Middle College had been. The Gymnasium (1920) was designed as an oversized replica of the John Hancock house in Boston, and had a wing added in 1951. Cutler Hall (1922), now Ellsworth Hall, was designed by James Ellsworth with a dining hall on the first floor, and the upper two floors for underclassmen dormitories. Hobart House (1935) and Wilson Hall (1962-63) were built as needed by the expanding Academy. While Wilson Hall resembles Seymour in being somewhat Transitional in design, Hobart House is simply an utilitarian brick building.

There are various houses surrounding the campus that are currently involved in the Academy affairs or have been part of College and Academy history. The oldest farmhouse still standing in Summit County was built by David Hudson in 1806. During successive generations there were interior and exterior changes made in the house. After the death of the last Hudson descendant to live in the village, the Academy purchased the house and restored it as close as possible to the simply copy of an early Connecticut farmhouse it originally was.

Simeon Porter designed a house for Professor Nathan Seymour (1841) on Prospect Street that has changed very little internally or externally over the years. The front doorway of this brick Greek Revival is a classic example of the Greek ideals expressed architecturally.

The northernmost area of the campus contains Cartwright House; a Tuscan house built c. 1875, and President Pierce's house. This latter building was built from 1851-54, and is a large rambling two-story Greek Revival. Further south on College Street is Cutler House (1835-40) named for Carrol Cutler, President of WRC 1860-82. It was originally only a square brick section, the wing was added later. There is a narrow spiral staircase immediately inside the entrance and to the left of the central hall.

NATIONAL REGISTER OF HISTORIC PLACES  
INVENTORY - NOMINATION FORM

(Continuation Sheet)

STATE		OHIO
COUNTY		SUMMIT
FOR NPS USE ONLY		
ENTRY NUMBER	DATE	

(Number all entries) Physical Appearance, Page -3-

Around the corner on Hudson Street is Morley Cottage (c. 1835) which is shaped in the cross pattern on a simple scale. The only decoration on the building is below the windows. Further up the street is Nutting House (1831) built for Professor Nutting, and later known as the Slaughter House when used for a dining hall by college boys. The doorway is notable as a local somewhat crude copy of an Adam design. While the fanlight is quite good, the "rosettes" around the door have been likened to doughnuts. There is another simple cottage built for Professor Potwin, a physicist at the college from 1873-82. At 120 Hudson Street, is the only gambrel roof in the area. It was built in 1832 by Leander Starr for Elizur Wright, Jr., and for many years was known as the Hosford House for the Reverend Henry B. Hosford, minister and professor at Western Reserve College.

At the corner of Aurora and Oviatt Streets is the William E. Crisp house (c. 1835). During the 1840's, this house was used as a boarding house for college students. It has been of necessity modernized inside, but is basically the same simple gable construction described by both I.T. Frary and R.N. Campen as Vernacular.



NATIONAL REGISTER OF HISTORIC PLACES  
INVENTORY - NOMINATION FORM

(Continuation Sheet)

STATE	
OHIO	
COUNTY	
SUMMIT	
FOR NPS USE ONLY	
ENTRY NUMBER	DATE

(Number all entries)

STATEMENT OF SIGNIFICANCE CONTINUED - Page 2

transferred to an independent corporation of his instigation and in 1916 the academy re-opened under his strong endowment. At one point, 1919-20, the academy was serving the village and township as a high school, under a tuition plan paid by the local school district. Co-education was phased out in 1925, but returned in 1972 with girls currently both day and resident students.

The additional buildings added when WRA took over the entire campus have been harmonized with the existing buildings. As stated in the articles of agreement in 1916, Mr. Ellsworth called for any additional buildings to be "colonial architecture so as to harmonize with the present buildings." To a large extent, this dictum has been followed. In the almost century and a half the academy has been part of the community of Hudson it has contributed both in architecture and thought to the area and has become an integral part of the Hudson scene.

NATIONAL REGISTER OF HISTORIC PLACES  
PROPERTY PHOTOGRAPH FORM

(Type all entries - attach to or enclose with photograph)

STATE OHIO	
COUNTY SUMMIT	
FOR NPS USE ONLY	
ENTRY NUMBER	DATE

SEE INSTRUCTIONS

<b>1. NAME</b>			
COMMON:		Western Reserve Academy	
AND/OR HISTORIC:		Western Reserve College & Academy	
<b>2. LOCATION</b>			
STREET AND NUMBER: (See Continuation Sheet)			
CITY OR TOWN: Hudson			
STATE:	CODE	COUNTY:	CODE
Ohio	039	Summit	153
<b>3. PHOTO REFERENCE</b>			
PHOTO CREDIT:		W. Doliber	
DATE OF PHOTO:		May 1971	
NEGATIVE FILED AT:		WRA	
<b>4. IDENTIFICATION</b>			
DESCRIBE VIEW, DIRECTION, ETC. North Hall: western facade facing College Street. Note details of pilasters both on the doorway and the windows above the doorway. ( 147 College Street)			

NATIONAL REGISTER OF HISTORIC PLACES  
PROPERTY PHOTOGRAPH FORM

(Type all entries - attach to or enclose with photograph)

STATE	OHIO	
COUNTY	SUMMIT	
FOR NPS USE ONLY		
ENTRY NUMBER	DATE	

SEE INSTRUCTIONS

<b>1. NAME</b>			
COMMON:	Western Reserve Academy		
AND/OR HISTORIC:	Western REserve College & Academy		
<b>2. LOCATION</b>			
STREET AND NUMBER: (See continuation sheet)			
CITY OR TOWN: Hudson			
STATE:	Ohio	CODE	COUNTY: Summit
		039	CODE
			153
<b>3. PHOTO REFERENCE</b>			
PHOTO CREDIT:	W. Doliber		
DATE OF PHOTO:	May 1974		
NEGATIVE FILED AT:	WRA		
<b>4. IDENTIFICATION</b>			
DESCRIBE VIEW, DIRECTION, ETC. Cartwright House: eastern facade facing College Street shows the elaborate detailing of this Tuscan house built circa 1875. (204 College Street)			

NATIONAL REGISTER OF HISTORIC PLACES  
PROPERTY PHOTOGRAPH FORM

(Type all entries - attach to or enclose with photograph)

STATE	OHIO	
COUNTY	SUMMIT	
FOR NPS USE ONLY		
ENTRY NUMBER	DATE	

SEE INSTRUCTIONS

<b>1. NAME</b>			
COMMON:	Western Reserve Academy		
AND/OR HISTORIC:	Western Reserve College & Academy		
<b>2. LOCATION</b>			
STREET AND NUMBER: (See Continuation Sheet)			
CITY OR TOWN: Hudson			
STATE:	Ohio	CODE	COUNTY: Summit
		039	CODE
			153
<b>3. PHOTO REFERENCE</b>			
PHOTO CREDIT:	W. Doliber		
DATE OF PHOTO:	May, 1974		
NEGATIVE FILED AT:	WRA		
<b>4. IDENTIFICATION</b>			
DESCRIBE VIEW, DIRECTION, ETC. President Pierce's House: Now the Headmaster's home, this western exposure shows the northern wing, the palladian window with balcony above the porticoed doorway. (169 College Street)			

NATIONAL REGISTER OF HISTORIC PLACES  
PROPERTY PHOTOGRAPH FORM

(Type all entries - attach to or enclose with photograph)

STATE, OHIO	
COUNTY SUMMIT	
FOR NPS USE ONLY	
ENTRY NUMBER	DATE

SEE INSTRUCTIONS

<b>1. NAME</b>			
COMMON:	Western Reserve Academy		
AND/OR HISTORIC:	Western R serve College & Academy		
<b>2. LOCATION</b>			
STREET AND NUMBER: (See Continuation Sheet)			
CITY OR TOWN: Hudson			
STATE:	OHIO	CODE	COUNTY: Summit
		039	153
<b>3. PHOTO REFERENCE</b>			
PHOTO CREDIT:	W. Doliber		
DATE OF PHOTO:	May 1974		
NEGATIVE FILED AT:	WRA		
<b>4. IDENTIFICATION</b>			
DESCRIBE VIEW, DIRECTION, ETC. Carrol Cutler House: western facade showing both original building and added wing. Photo shows the Greek REvival doorway details clearly. (169 College Street)			

NATIONAL REGISTER OF HISTORIC PLACES  
PROPERTY PHOTOGRAPH FORM

(Type all entries - attach to or enclose with photograph)

STATE OHIO	
COUNTY SUMMIT	
FOR NPS USE ONLY	
ENTRY NUMBER	DATE

SEE INSTRUCTIONS

<b>1. NAME</b>			
COMMON:	Western Reserve Academy		
AND/OR HISTORIC:	Western Reserve College & Academy		
<b>2. LOCATION</b>			
STREET AND NUMBER: (See Continuation Sheet)			
CITY OR TOWN: Hudson			
STATE:	OHIO	CODE	COUNTY: Summit
		039	153
<b>3. PHOTO REFERENCE</b>			
PHOTO CREDIT:	W. Doliber		
DATE OF PHOTO:	May 1974		
NEGATIVE FILED AT:	WRA		
<b>4. IDENTIFICATION</b>			
DESCRIBE VIEW, DIRECTION, ETC. President's House: view of west facade from College St., showing the double doorways. Built in 1829-30, this early Federal bldg. was originally designed to house the President of the College and the Professor of Theology. 153-155 College Street.			

NATIONAL REGISTER OF HISTORIC PLACES

PROPERTY PHOTOGRAPH FORM

(Type all entries - attach to or enclose with photograph)

STATE OHIO	
COUNTY SUMMIT	
FOR NPS USE ONLY	
ENTRY NUMBER	DATE

SEE INSTRUCTIONS

<b>1. NAME</b>			
COMMON: Western Reserve Academy		AND/OR HISTORIC: Western Reserve College & Academy	
<b>2. LOCATION</b>			
STREET AND NUMBER: (See Continuation Sheet)			
CITY OR TOWN: Hudson			
STATE: Ohio	CODE 039	COUNTY: Summit	CODE 153
<b>3. PHOTO REFERENCE</b>			
PHOTO CREDIT: W. Doliber		DATE OF PHOTO: May 1974	
NEGATIVE FILED AT: WRA			
<b>4. IDENTIFICATION</b>			
DESCRIBE VIEW, DIRECTION, ETC. Seymour-Burnham House: souther facade showing classic Greek Revival doorway. (15 Prospect Street)			

NATIONAL REGISTER OF HISTORIC PLACES

PROPERTY PHOTOGRAPH FORM

(Type all entries - attach to or enclose with photograph)

STATE OHIO	
COUNTY SUMMIT	
FOR NPS USE ONLY	
ENTRY NUMBER	DATE

SEE INSTRUCTIONS

<b>1. NAME</b>			
COMMON: Western Reserve Academy		AND/OR HISTORIC: Western Reserve College & Academy	
<b>2. LOCATION</b>			
STREET AND NUMBER: (See Continuation Sheet)			
CITY OR TOWN: Hudson			
STATE: Ohio	CODE 039	COUNTY: Summit	CODE 153
<b>3. PHOTO REFERENCE</b>			
PHOTO CREDIT: W. Doliber		DATE OF PHOTO: May 1974	
NEGATIVE FILED AT: WRA			
<b>4. IDENTIFICATION</b>			
DESCRIBE VIEW, DIRECTION, ETC. Morley Cottage: souther exposure of the house, showing lights around both doorways and simple paneling below the windows. The photo also shows the cross pattern of the house. (73 Hudson Street)			

**NATIONAL REGISTER OF HISTORIC PLACES  
PROPERTY PHOTOGRAPH FORM**

(Type all entries - attach to or enclose with photograph)

STATE OHIO	
COUNTY SUMMIT	
FOR NPS USE ONLY	
ENTRY NUMBER	DATE

SEE INSTRUCTIONS

<b>1. NAME</b>			
COMMON:		Western Reserve Academy	
AND/OR HISTORIC:		Western Reserve College & Academy	
<b>2. LOCATION</b>			
STREET AND NUMBER: (See Continuation Sheet)			
CITY OR TOWN: Hudson			
STATE:	CODE	COUNTY:	CODE
Ohio	039	Summit	153
<b>3. PHOTO REFERENCE</b>			
PHOTO CREDIT:		W. Doliber	
DATE OF PHOTO:		May 1974	
NEGATIVE FILED AT:		WRA	
<b>4. IDENTIFICATION</b>			
DESCRIBE VIEW, DIRECTION, ETC. The Observatory: Shown from the northwest side showing both the north and west sides of the building. (86 College Street)			

**NATIONAL REGISTER OF HISTORIC PLACES  
PROPERTY PHOTOGRAPH FORM**

(Type all entries - attach to or enclose with photograph)

STATE OHIO	
COUNTY SUMMIT	
FOR NPS USE ONLY	
ENTRY NUMBER	DATE

SEE INSTRUCTIONS

<b>1. NAME</b>			
COMMON:		Western Reserve Academy	
AND/OR HISTORIC:		Western Reserve College & Academy	
<b>2. LOCATION</b>			
STREET AND NUMBER: (See Continuation Sheet)			
CITY OR TOWN: Hudson			
STATE:	CODE	COUNTY:	CODE
Ohio	039	Summit	153
<b>3. PHOTO REFERENCE</b>			
PHOTO CREDIT:		W. Doliber	
DATE OF PHOTO:		May 1974	
NEGATIVE FILED AT:		WRA	
<b>4. IDENTIFICATION</b>			
DESCRIBE VIEW, DIRECTION, ETC. Athenaeum: western facade showing the blind arcades similar to the ones on the chapel. The entrance in the photo is the main one used since 1916 when the building was changed from three to four stories. (87 College Street)			

NATIONAL REGISTER OF HISTORIC PLACES  
PROPERTY PHOTOGRAPH FORM

(Type all entries - attach to or enclose with photograph)

STATE OHIO	
COUNTY SUMMIT	
FOR NPS USE ONLY	
ENTRY NUMBER	DATE

SEE INSTRUCTIONS

<b>1. NAME</b>			
COMMON: Western Reserve Academy		AND/OR HISTORIC: Western Reserve College & Academy	
<b>2. LOCATION</b>			
STREET AND NUMBER: (See Continuation Sheet)			
CITY OR TOWN: Hudson			
STATE: Ohio	CODE 039	COUNTY: Summit	CODE 153
<b>3. PHOTO REFERENCE</b>			
PHOTO CREDIT: W. Doliber			
DATE OF PHOTO: May 1974			
NEGATIVE FILED AT: WRA			
<b>4. IDENTIFICATION</b>			
DESCRIBE VIEW, DIRECTION, ETC. Potwin Cottage: southern exposure of the simple cottage, showing the red tile roof added in James Ellsworth time and influence as was done to many other older homes in Hudson. (97 Hudson Street)			

NATIONAL REGISTER OF HISTORIC PLACES  
PROPERTY PHOTOGRAPH FORM

(Type all entries - attach to or enclose with photograph)

STATE OHIO	
COUNTY SUMMIT	
FOR NPS USE ONLY	
ENTRY NUMBER	DATE

SEE INSTRUCTIONS

<b>1. NAME</b>			
COMMON: Western Reserve Academy		AND/OR HISTORIC: Western Reserve College & Academy	
<b>2. LOCATION</b>			
STREET AND NUMBER: (See Continuation Sheet)			
CITY OR TOWN: Hudson			
STATE: Ohio	CODE 039	COUNTY: Summit	CODE 153
<b>3. PHOTO REFERENCE</b>			
PHOTO CREDIT: W. Doliber			
DATE OF PHOTO: May 1974			
NEGATIVE FILED AT: WRA			
<b>4. IDENTIFICATION</b>			
DESCRIBE VIEW, DIRECTION, ETC. The Chapel: western facade from College St., one sees the Doric pilasters, below the Doric entablature; and also the pediment window with globe-of-the-world tracery. The tower, with its two remaining tiers contains the clock and bells. (135 College Street)			

NATIONAL REGISTER OF HISTORIC PLACES  
PROPERTY PHOTOGRAPH FORM

(Type all entries - attach to or enclose with photograph)

STATE		OHIO	
COUNTY		SUMMIT	
FOR NPS USE ONLY			
ENTRY NUMBER	DATE		

SEE INSTRUCTIONS

<b>1. NAME</b>			
COMMON:		Western Reserve Academy	
AND/OR HISTORIC:		Western Reserve College & Academy	
<b>2. LOCATION</b>			
STREET AND NUMBER:			
(See Continuation Sheet)			
CITY OR TOWN:			
Hudson			
STATE:	CODE	COUNTY:	CODE
Ohio	039	Summit	153
<b>3. PHOTO REFERENCE</b>			
PHOTO CREDIT:		W. Doliber	
DATE OF PHOTO:		May 1974	
NEGATIVE FILED AT:		WRA	
<b>4. IDENTIFICATION</b>			
DESCRIBE VIEW, DIRECTION, ETC.			
Nutting House: souther facade facing Hudson Street, featuring the recessed lighted doorway surrounded by the Adam-inspired elaborate molding. (79 Hudson Street)			

NATIONAL REGISTER OF HISTORIC PLACES  
PROPERTY PHOTOGRAPH FORM

(Type all entries - attach to or enclose with photograph)

STATE		Ohio	
COUNTY		Summit	
FOR NPS USE ONLY			
ENTRY NUMBER	DATE		

SEE INSTRUCTIONS

<b>1. NAME</b>			
COMMON:		Western Reserve Academy	
AND/OR HISTORIC:		Western Reserve College & Academy	
<b>2. LOCATION</b>			
STREET AND NUMBER:			
(See Continuation Sheet)			
CITY OR TOWN:			
Hudson			
STATE:	CODE	COUNTY:	CODE
Ohio	039	Summit	153
<b>3. PHOTO REFERENCE</b>			
PHOTO CREDIT:		W. Doliber	
DATE OF PHOTO:		May 1974	
NEGATIVE FILED AT:		WRA	
<b>4. IDENTIFICATION</b>			
DESCRIBE VIEW, DIRECTION, ETC.			
Hudson House: A view from North Main looking northwest at the front and south side. Built in 1806, it has recently been restored to the original style of Connecticut farmhouse. (North Main Street)			



NATIONAL REGISTER OF HISTORIC PLACES  
PROPERTY MAP FORM

(Type all entries - attach to or enclose with map)

STATE	OHIO	
COUNTY	SUMMIT	
FOR NPS USE ONLY		
ENTRY NUMBER	DATE	

SEE INSTRUCTIONS

<b>1. NAME</b>			
COMMON:	Western Reserve Academy		
AND/OR HISTORIC:	Western Reserve College & Academy		
<b>2. LOCATION</b>			
STREET AND NUMBER:			
Aurore, N. Main, Prospect, College Streets (1 block of Oviatt St.)			
CITY OR TOWN:			
Hudson			
STATE:	CODE	COUNTY:	CODE
Ohio	039	Summit	153
<b>3. MAP REFERENCE</b>			
SOURCE:			
U.S.G.S. - Summit County Engineers Office			
SCALE:			
1:24,000			
DATE:			
1963 (photorevised 1970)			
<b>4. REQUIREMENTS</b>			
TO BE INCLUDED ON ALL MAPS			
1. Property boundaries where required.			
2. North arrow.			
3. Latitude and longitude reference.			

NATIONAL REGISTER OF HISTORIC PLACES  
PROPERTY PHOTOGRAPH FORM

FOR NPS USE ONLY
RECEIVED
DATE ENTERED

SEE INSTRUCTIONS IN *HOW TO COMPLETE NATIONAL REGISTER FORMS*  
TYPE ALL ENTRIES ENCLOSE WITH PHOTOGRAPH

**1** NAME

HISTORIC Western Reserve College & Academy

AND/OR COMMON Western Reserve Academy

**2** LOCATION

CITY, TOWN Hudson VICINITY OF COUNTY Summit STATE Ohio

**3** PHOTO REFERENCE

PHOTO CREDIT Barney Oldfield

DATE OF PHOTO May, 1975

NEGATIVE FILED AT

**4** IDENTIFICATION

DESCRIBE VIEW, DIRECTION, ETC. IF DISTRICT, GIVE BUILDING NAME & STREET

PHOTO NO.

Harlan N. Wood House. This view faces east on Oviatt St. and Hudson St.  
It is position C on the map of the Historic District.

NATIONAL REGISTER OF HISTORIC PLACES  
PROPERTY PHOTOGRAPH FORM

FOR NPS USE ONLY
RECEIVED
DATE ENTERED

SEE INSTRUCTIONS IN *HOW TO COMPLETE NATIONAL REGISTER FORMS*  
TYPE ALL ENTRIES ENCLOSE WITH PHOTOGRAPH

**1** NAME

HISTORIC Western Reserve College & Academy

AND/OR COMMON Western Reserve Academy

**2** LOCATION

CITY, TOWN Hudson VICINITY OF COUNTY Summit STATE Ohio

**3** PHOTO REFERENCE

PHOTO CREDIT Barney Oldfield

DATE OF PHOTO May, 1975

NEGATIVE FILED AT Western Reserve Academy

**4** IDENTIFICATION

DESCRIBE VIEW, DIRECTION, ETC. IF DISTRICT, GIVE BUILDING NAME & STREET

PHOTO NO.

Newton B. Hobart House, Prospect St. This view is from the south  
facing Prospect St. This house is position B on the Historic District Map.

UNITED STATES DEPARTMENT OF THE INTERIOR  
NATIONAL PARK SERVICE

NATIONAL REGISTER OF HISTORIC PLACES  
PROPERTY PHOTOGRAPH FORM

FOR NPS USE ONLY
RECEIVED
DATE ENTERED

SEE INSTRUCTIONS IN HOW TO COMPLETE NATIONAL REGISTER FORMS  
TYPE ALL ENTRIES ENCLOSE WITH PHOTOGRAPH

**1** NAME

HISTORIC Western Reserve College & Academy

AND/OR COMMON Western Reserve Academy

**2** LOCATION

CITY, TOWN Hudson VICINITY OF COUNTY Summit STATE Ohio

**3** PHOTO REFERENCE

PHOTO CREDIT Barney Oldfield

DATE OF PHOTO May, 1975

NEGATIVE FILED AT Western Reserve Academy

**4** IDENTIFICATION

DESCRIBE VIEW, DIRECTION, ETC. IF DISTRICT, GIVE BUILDING NAME & STREET

PHOTO NO.

Bicknell Gymnasium. This view is facing West on College St.  
This building is position 18 on the Historic District Map.

NATIONAL REGISTER OF HISTORIC PLACES  
PROPERTY PHOTOGRAPH FORM

RECEIVED
DATE ENTERED

SEE INSTRUCTIONS IN HOW TO COMPLETE NATIONAL REGISTER FORMS  
TYPE ALL ENTRIES ENCLOSE WITH PHOTOGRAPH

**1** NAME

HISTORIC Western Reserve College & Academy

AND/OR COMMON Western Reserve Academy

**2** LOCATION

CITY, TOWN Hudson VICINITY OF COUNTY Summit STATE Ohio

**3** PHOTO REFERENCE

PHOTO CREDIT Barney Oldfield

DATE OF PHOTO May, 1975

NEGATIVE FILED AT Western Reserve Academy

**4** IDENTIFICATION

DESCRIBE VIEW, DIRECTION, ETC. IF DISTRICT, GIVE BUILDING NAME & STREET

PHOTO NO.

Robert S. Wilson Hall. This view is facing north on the corner of  
Aurora St. & Oviatt St. It is position 13 on the Historic District Map.

NATIONAL REGISTER OF HISTORIC PLACES  
PROPERTY PHOTOGRAPH FORM

FOR NPS USE ONLY
RECEIVED
DATE ENTERED

SEE INSTRUCTIONS IN *HOW TO COMPLETE NATIONAL REGISTER FORMS*  
TYPE ALL ENTRIES ENCLOSE WITH PHOTOGRAPH

**1** NAME

HISTORIC Western Reserve College & Academy

AND/OR COMMON Western Reserve Academy

**2** LOCATION

CITY, TOWN Hudson VICINITY OF COUNTY Summit STATE Ohio

**3** PHOTO REFERENCE

PHOTO CREDIT Barney Oldfield

DATE OF PHOTO May, 1975

NEGATIVE FILED AT Western Reserve Academy

**4** IDENTIFICATION

DESCRIBE VIEW, DIRECTION, ETC. IF DISTRICT, GIVE BUILDING NAME & STREET

PHOTO NO.

Ellsworth Hall. This view is looking east on the corner of College St. and Prospect. It is position A on the Historic District Map.

NATIONAL REGISTER OF HISTORIC PLACES  
PROPERTY PHOTOGRAPH FORM

RECEIVED
DATE ENTERED

SEE INSTRUCTIONS IN *HOW TO COMPLETE NATIONAL REGISTER FORMS*  
TYPE ALL ENTRIES ENCLOSE WITH PHOTOGRAPH

**1** NAME

HISTORIC Western Reserve College & Academy

AND/OR COMMON Western Reserve Academy

**2** LOCATION

CITY, TOWN Hudson VICINITY OF COUNTY Summit STATE Ohio

**3** PHOTO REFERENCE

PHOTO CREDIT Barney Oldfield

DATE OF PHOTO May, 1975

NEGATIVE FILED AT Western Reserve Academy

**4** IDENTIFICATION

DESCRIBE VIEW, DIRECTION, ETC. IF DISTRICT, GIVE BUILDING NAME & STREET

PHOTO NO.

Seymour Hall, College St. This view is from the northeast on College Row. The building faces West. It is position 12 on the Historic District Ma

461

27'30"

462

SOLON 9 MI. TWINSBURG 4.3 MI. 4766 IV SW (TWINSBURG)

464

465 25' 2 300 000 FEET

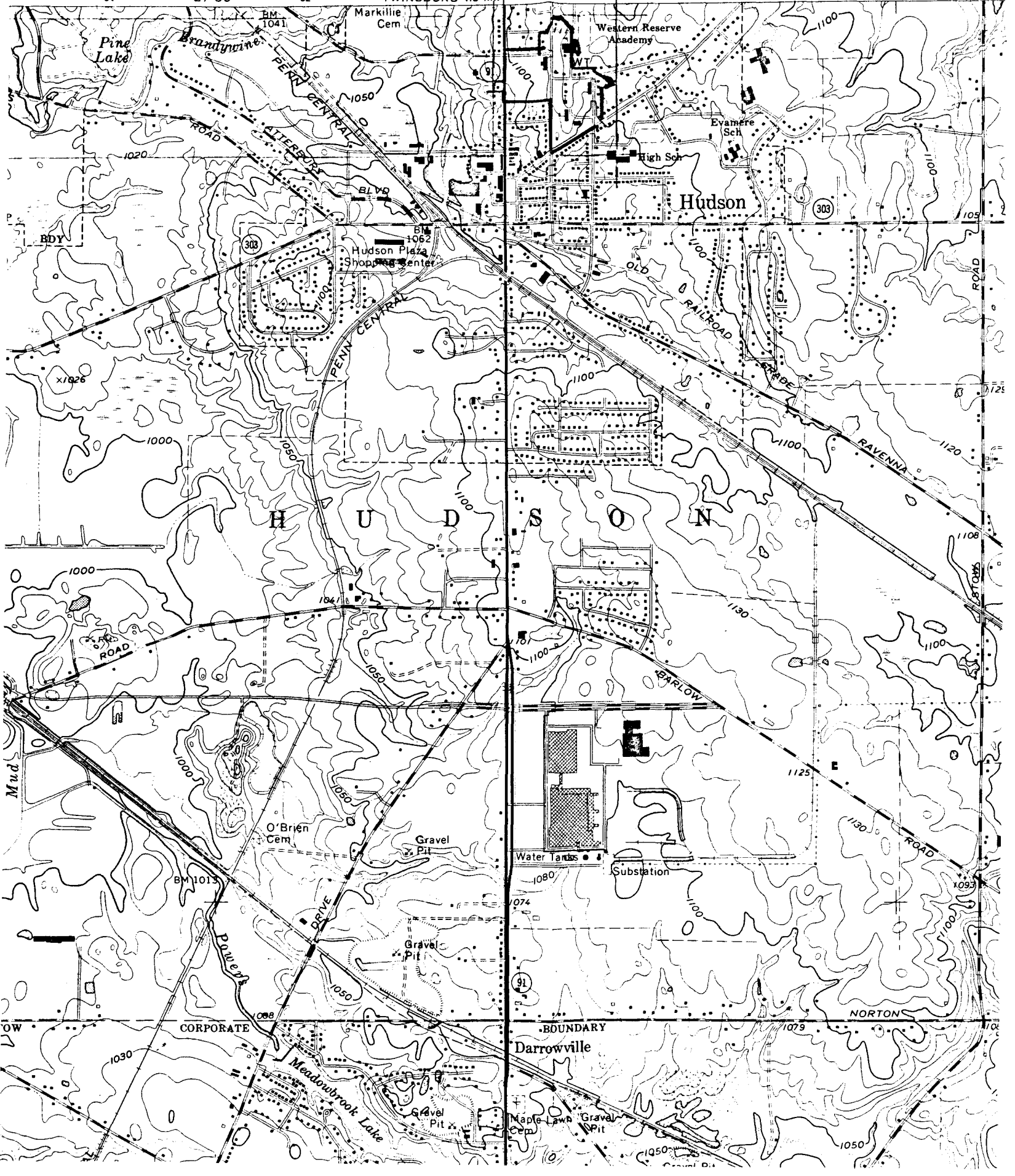

July 25, 1975

Western Reserve Academy  
Office of the Headmaster  
Hudson, Ohio 44236

Dear Sir:

I am pleased to inform you that the Western Reserve Academy, Western Reserve College, Hudson, has been entered in the National Register of Historic Places by the National Park Service, United States Department of the Interior.

The nomination was made in connection with a state plan to identify and document prehistoric and historic places in Ohio which qualify for National Register status under provisions of the National Historic Preservation Act of 1966. All nominations are approved by the Ohio Historic Site Preservation Advisory Board.

Enclosed is a brochure explaining the purposes and goals of the National Register of Historic Places.

Sincerely,



Thomas H. Smith  
Director, Ohio Historical Society  
State Historic Preservation Officer

TS/eml  
enclosure

X.c: Mayor of Hudson  
Eric Johannesen, Western Reserve Historical Society

**Ohio Historic Preservation Office**  
**Ohio Historical Center I-71 & 17th Avenue Columbus, Ohio 43211 (614) 466-8727**

# Ohio Historic Preservation Office

## National Register of Historic Places File Checklist

The following materials are contained in this file of the National Register form for:

Name: Western Reserve Academy

County: Summit

Original National Register of Historic Places nomination form

Multiple Property Nomination form

Photograph(s)

Photograph(s) (copies)

USGS map(s)

USGS map(s) (copies)

Sketch map(s)/figure(s)/exhibit(s)

Correspondence

Other news clips, brochure

\_\_\_\_\_  
\_\_\_\_\_